

Assembly and Installation Instructions for the PARTITION

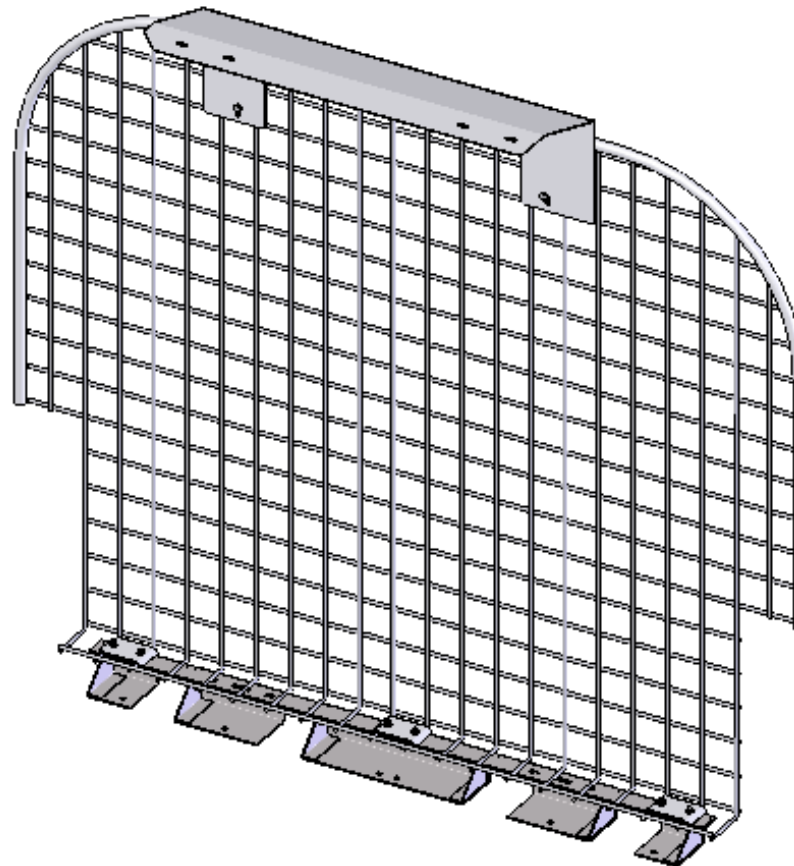

1-800-222-8785

www.masterack.com



PARTITION

RM479536

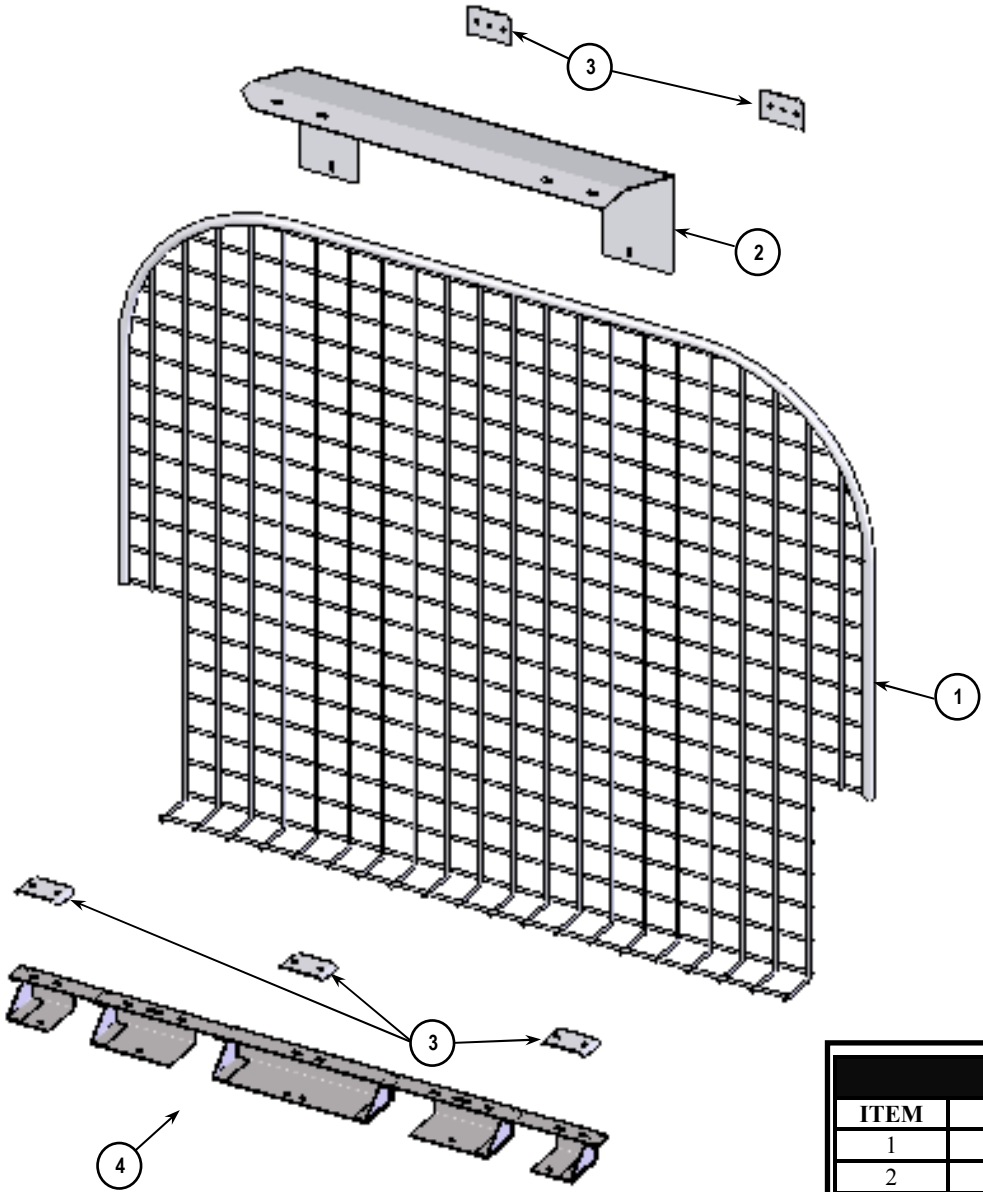

BILL OF COMPONENTS			
ITEM	PART #	QTY.	DESCRIPTION
1	02B399	1	PARTITION
2	02B402	1	TOP CLOSEOUT
3	144309	5	BRACKET
4	02B301	1	FLOOR BRACKET
5		1	HARDWARE BAG (NOT SHOWN)

PRECAUTIONS

1. **Before Installing the Partition into the van, the unit must be assembled.**
2. **Refer to parts list to make sure that all parts and hardware are included in the package before installation.**
3. **Always use a protective cover over rear bumper and side step, when unit is moved in or out of the vehicle so that the vehicle is not scratched.**

ASSEMBLY PREPARATION:

Review this sheet to ensure that all parts and hardware are included in the package before installation. In the event that parts are missing please contact **Leggett & Platt Commercial Vehicle Products at 1-800-321-4934**, to re-order missing parts.

TORQUE SETTINGS

BOLT SIZE	TORQUE (ft – lbs)
1/4	7-10
5/16	12-17
3/8	22-30

REQUIRED TOOLS FOR INSTALLATION.

Plus Nut Tool or Gun

Drill with 25/64" dia. Drill bit and 5/16" drill bit with Drill Stop

(See Fig. 1)

Air Ratchet with 7/16" Socket

7/16" Wrench

Phillips Head screw Driver or Screw Gun with Phillips Head Bit.

Review this document to ensure that all parts and hardware are included in the package, before installation.

In the event that parts are missing please contact Masterack @ 1-800-222-8785, to re-order missing parts.

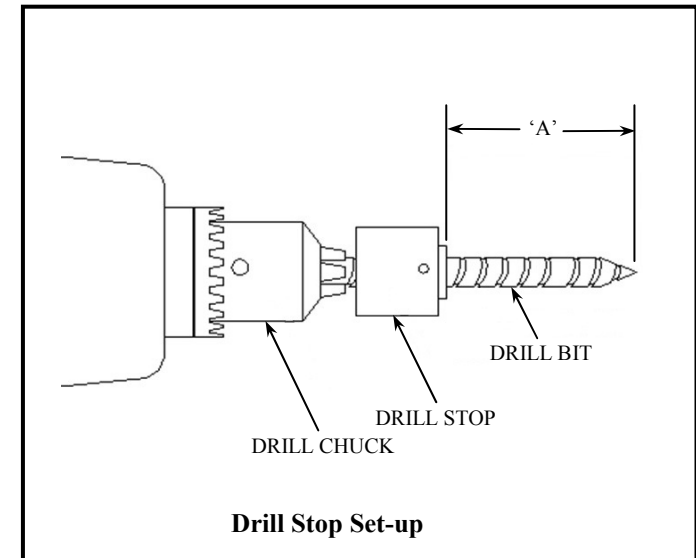

Fig 1



CHECK ALL LOCATIONS BEFORE DRILLING !

**TO PREVENT ANY DAMAGE TO
GAS LINES, GAS TANKS, BRAKE LINES, OR WIRING**

ATTACHING FLOOR BRACKET

RM479536

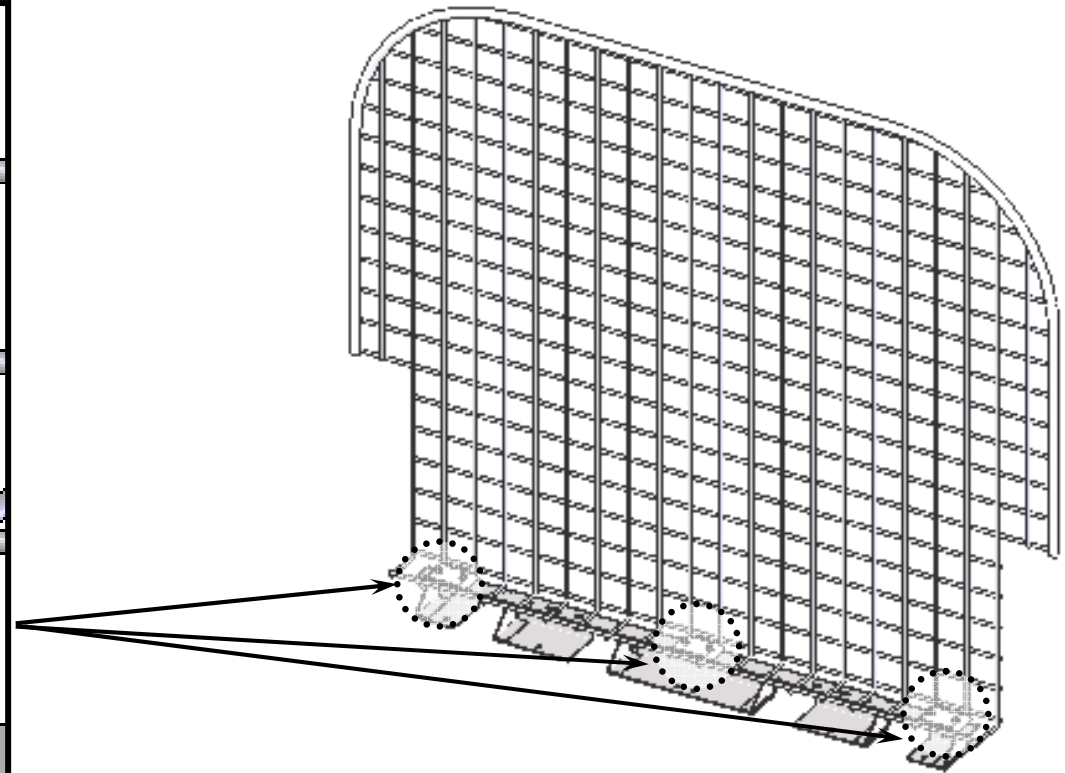
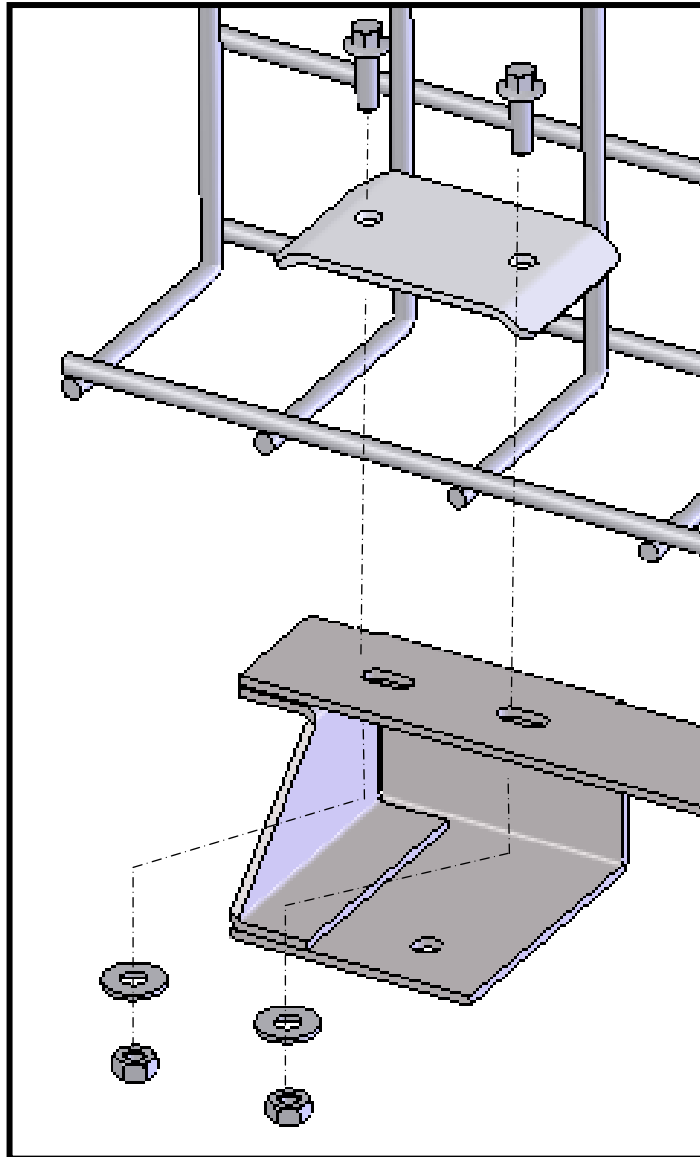

Attach Floor Bracket using;
(6) 1/4-20 x 3/4 GRD 5 HWH Screw
(6) 1/4 Flat Washers
(6) 1/4 1/4-20 E-Stop Nuts

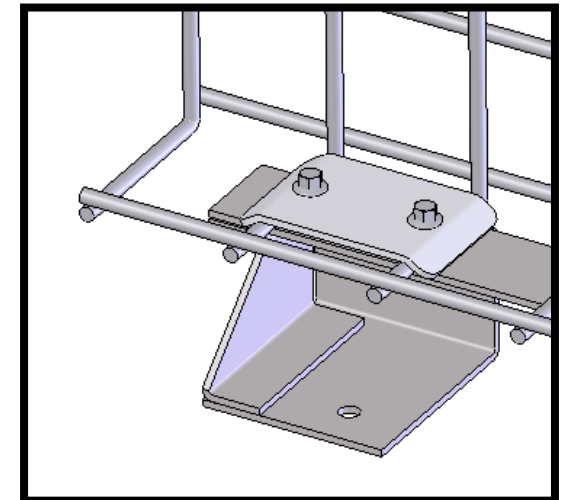

ATTACHING TOP CLOSEOUT

RM479536

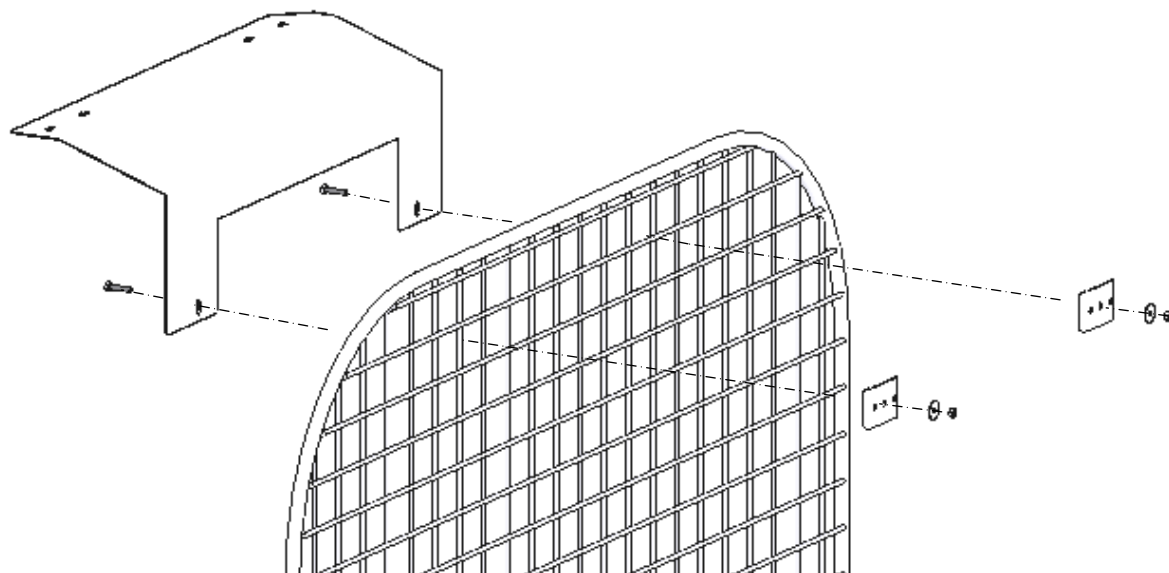
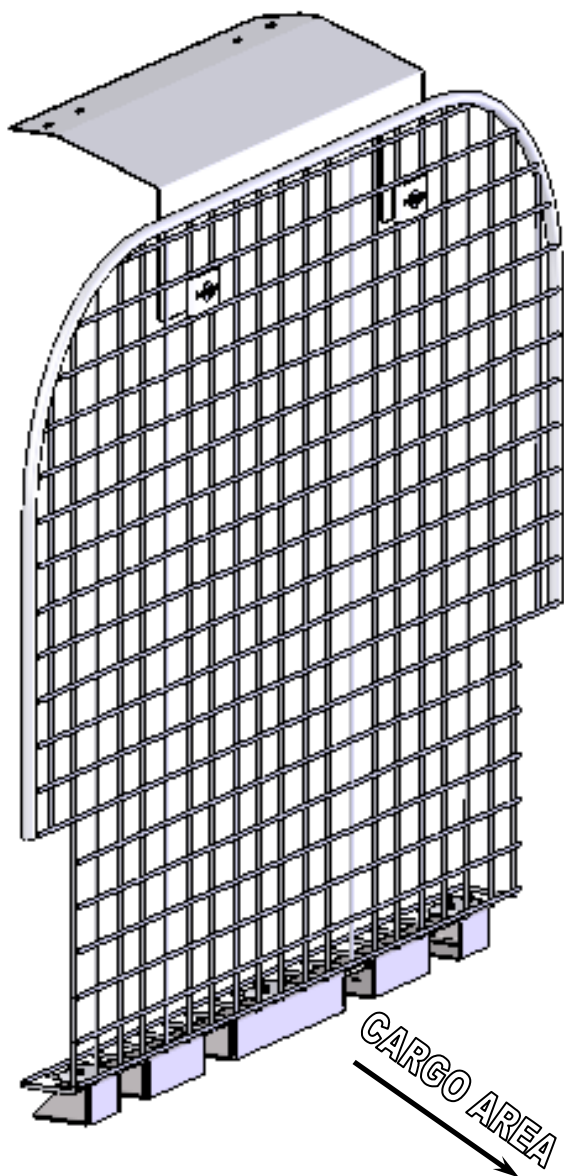

Attach Top Closeout using;
(4) 1/4-20 x 3/4 Hex Head Bolts
(4) 1/4 Flat Washers
(4) 1/4 1/4-20 E-Stop Nuts



MOUNTING LOCATIONS

RM479536

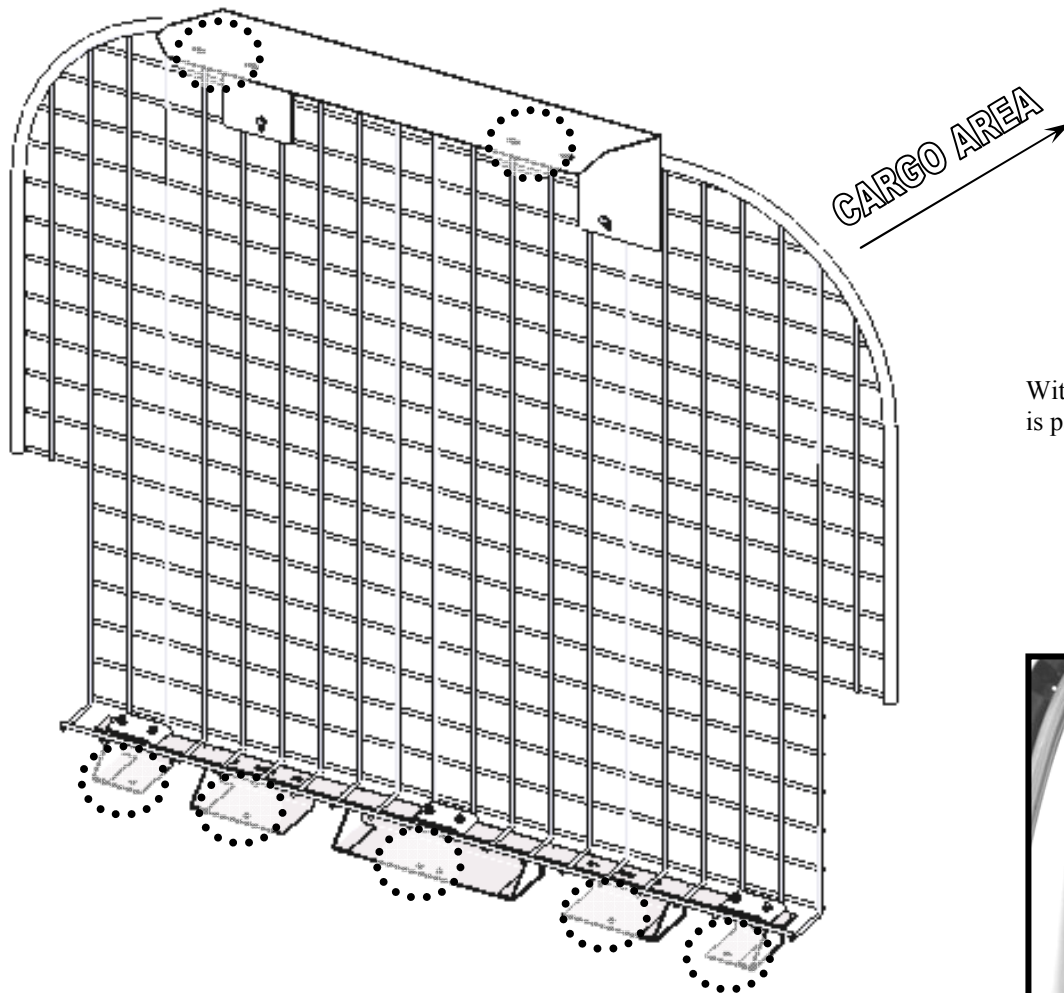

With Partition in the desired location, make sure Floor Bracket is parallel with the van floor. Mark the (7) mounting locations.



CHECK ALL LOCATIONS BEFORE DRILLING !
TO PREVENT ANY DAMAGE TO
GAS LINES, GAS TANKS, BRAKE LINES, OR WIRING



SECURING TO VEHICLE FLOOR

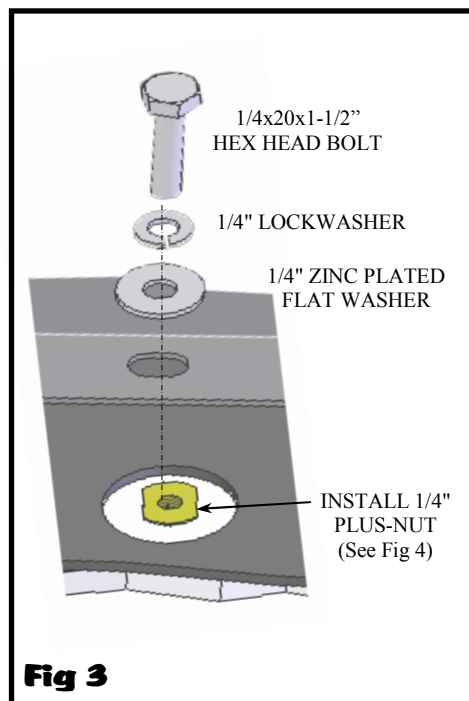
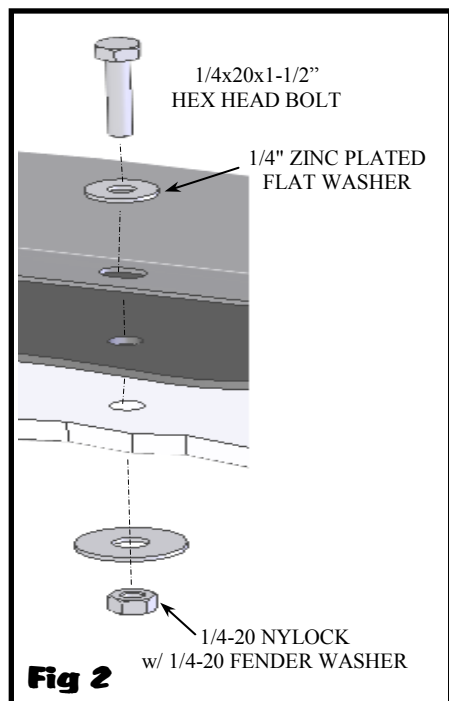

With Partition in the desired location, make sure Floor Bracket is parallel with the van floor. Use extreme care prior to drilling above the gas tank, and USE A DRILL STOP (See Fig 1). Secure Partition to vehicle floor as shown in Fig 2. An alternate method of securing the partition above gas tank is shown in Fig 3.

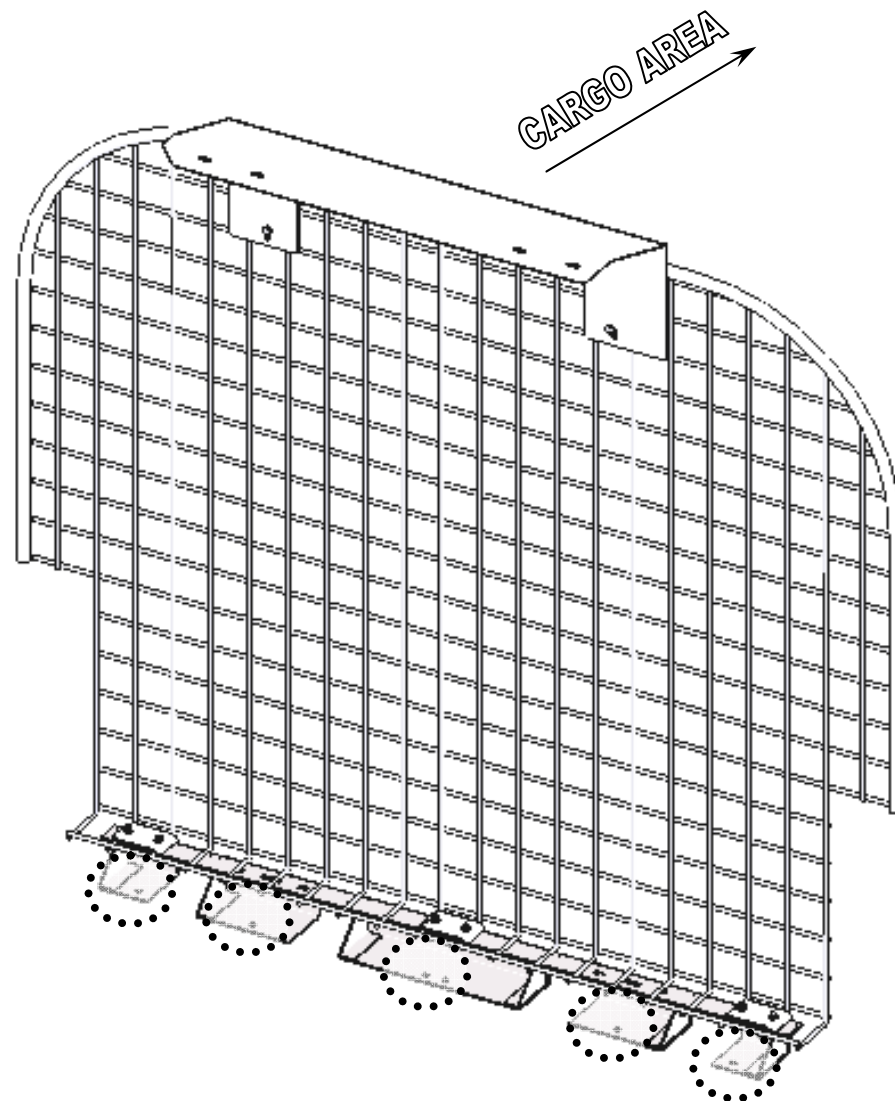

CHECK ALL LOCATIONS BEFORE DRILLING !
TO PREVENT ANY DAMAGE TO
GAS LINES, GAS TANKS, BRAKE LINES, OR WIRING

SECURING TO VEHICLE ROOF

RM479536

Plusnut Installation

1. The Plusnut is pre-bulbed for easy installation.

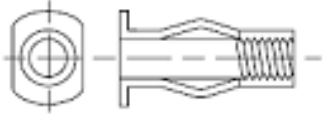

2. The Plusnut is preassembled with a hex cap and hex bolt. Then it is inserted into a predrilled hole.

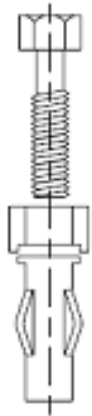

3. As the bolt is tightened, the Plusnut upsets and provides outstanding fastening holding power.

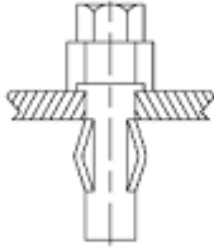

4. The C-500 Plusnut tool tightens bolt through hex head cap into Plusnut. A ratchet, open-end or closed-end wrench can be used.



5. A fully upset Plusnut provides a reliable nut for fastening.

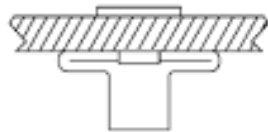
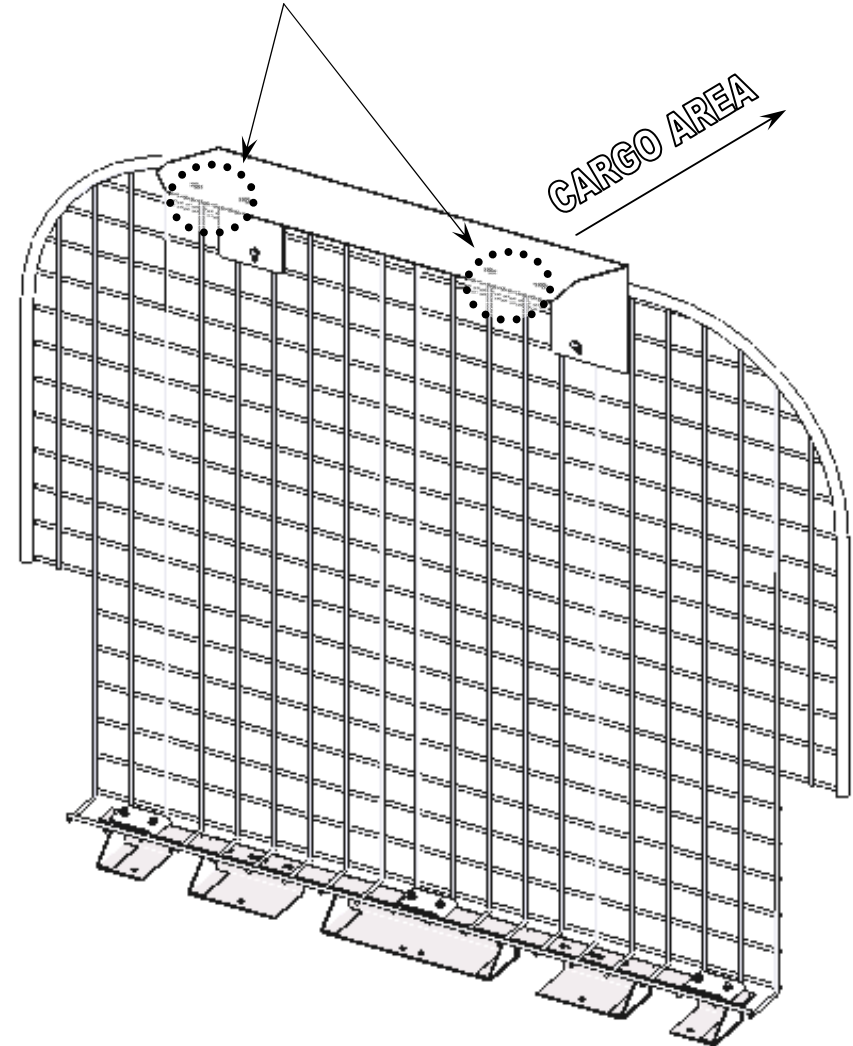

Fig 4

NOTE: Mark (2) hole locations to insert 1/4" Plus-Nuts to secure the Top Closeout.
(See Fig 4 for Plus-Nut installation)



CHECK ALL LOCATIONS BEFORE DRILLING !
TO PREVENT ANY DAMAGE TO
GAS LINES, GAS TANKS, BRAKE LINES, OR WIRING

Secure the Top Closeout
by aligning mounting hole with previously
installed Plus-Nuts
and secure using;

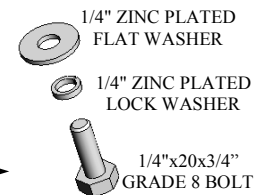



3 Year / 36,000 Mile Limited Warranty

MASTERACK® commercial van and pickup equipment is warranted to be from defects in material and workmanship, under normal use and service for a period of one (1) year from date of purchase. Factory installations, and products installed in new vehicles by an authorized MASTERACK® installer are warranted for **(3) years or 36,000 miles (60,000 KM)**, whichever comes first. **This warranty covers only repairs, or at MASTERACKS' discretion, replacement to correct any defects related to materials and workmanship.**

This warranty does not apply to:

- Additions, alterations, or installations made by persons including dealers, other than MASTERACK® and its authorized distributors, made in accordance with MASTERACK® specifications and / or instructions, nor to defects arising out of attribute to such additions, alterations or installations.
- Defects attributable to abuse or misuse of the product, misapplication, negligent accident, modification or tampering.
- Damage resulting from failure to promptly notify and comply with the instructions of the dealer or manufacturer about defects when noted.
- Any incidental or consequential damages connected with a defect, either while under warranty or afterward, including the cost of a rental truck and / or loss or revenue.

THE WARRANTY IS THE ONLY WARRANTY APPLICABLE TO A MASTERACK PRODUCT PURCHASE. ALL OTHER WARRANTIES, EXPRESSED OR IMPLIED, INCLUDING BUT NOT LIMITED TO, THE IMPLIED WARRANTIES OR MERCHANTABILITY AND FITNESS FOR A PARTICULAR PURPOSE ARE DISCLAIMED. MASTERACK® AND ITS SUBSIDIARIES, SHALL NOT BE LIABLE FOR ANY INCIDENTAL OR CONSEQUENTIAL DAMAGES ARISING OUT OF ANY BREACH OF THIS WARRANTY, NOR SHALL THE DAMAGES EXCEED THE RETURN AMOUNT OF THE PURCHASE PRICE PAID BY THE ORIGINAL PURCHASER.

Warranty claims must be submitted to either your sales representative or a customer service representative at **1-800-222-8785**. The vehicle must be delivered to the original MASTERACK® authorized dealer for inspection and any warranty service. Any warranty service to be performed by a source other than MASTERACK® location or an approved MASTERACK® distributor must be authorized in advance of the repairs by the MASTERACK® Warranty Administrator and a purchase order issued by MASTERACK® in advance of repairs for the authorized repairs.