

**FORD TRANSIT 3<sup>RD</sup> CROSSBOW LADDER RACK (02R124KP)**

**Recommended Tools**

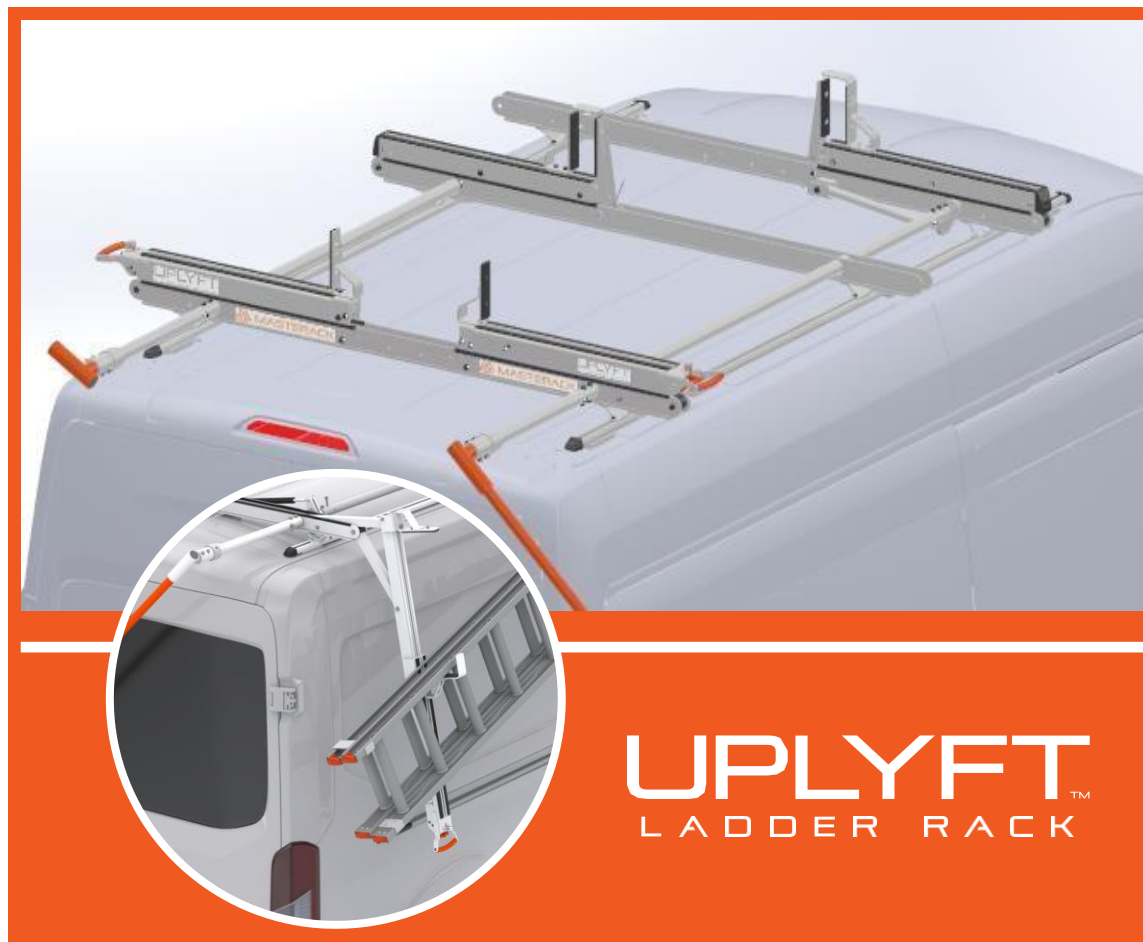

**UPLYFT™ LADDER RACK SYSTEM**

PN	DESCRIPTION	QTY
02P675	CROSSBOW ASSY – REAR	1
02P326	CROSSBOW ASSY - FRONT UPLYFT	1
02R122	CROSSBOW ASSY 3RD UPLYFT	1
02P328	CONNECTING TUBE - PWDR UPLYFT	1
02R038	CONNECTING TUBE 3RD CROSSBOW	1
02P103	DROP DOWN ASSEMBLY UPLYFT	2
02P393	MIDROOF HANDLE ASSY UPLYFT	1
02P663	LADDER STOP ASSY FRONT UPLYFT	2
02P664	LADDER STOP ASSY REAR UPLYFT	2
02P665	ROTATION ASSEMBLY MR UPLYFT	2
02P666	HARDWARE BAG UPLYFT	1

**Before installation, review this document to ensure that all parts and hardware are included in the package.**  
In the event that parts are missing, please contact Masterack at 1-800-222-8785 to re-order missing parts.

**BEFORE INSTALLATION PLEASE REVIEW THIS ENTIRE DOCUMENT, UNTIL YOU ARE COMPLETELY FAMILIAR WITH ALL STEPS BEFORE BEGINNING. A "PRACTICE RUN" OF THESE STEPS/PROCEDURES MAY BE HELPFUL TO ASSIST YOU IN FAMILIARIZING YOURSELF THOROUGHLY AND AVOID COSTLY ERRORS.**

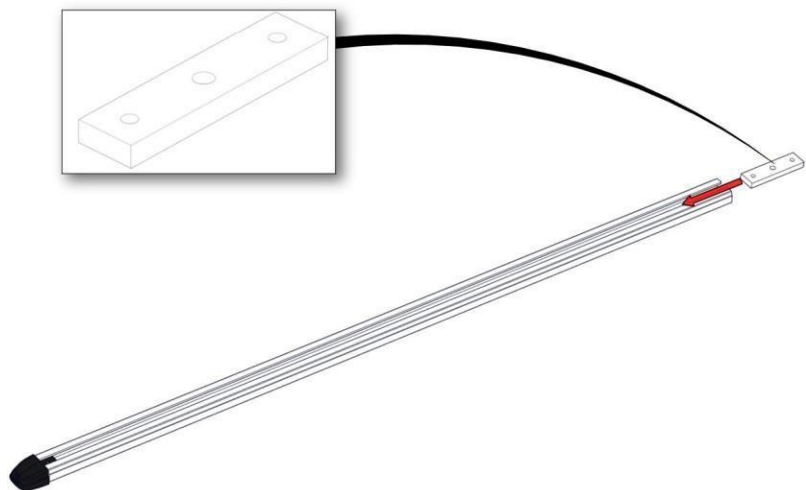

**Step 1.**

Slide receiver block (02P118) into each of the 4 mounting rails (02P112)

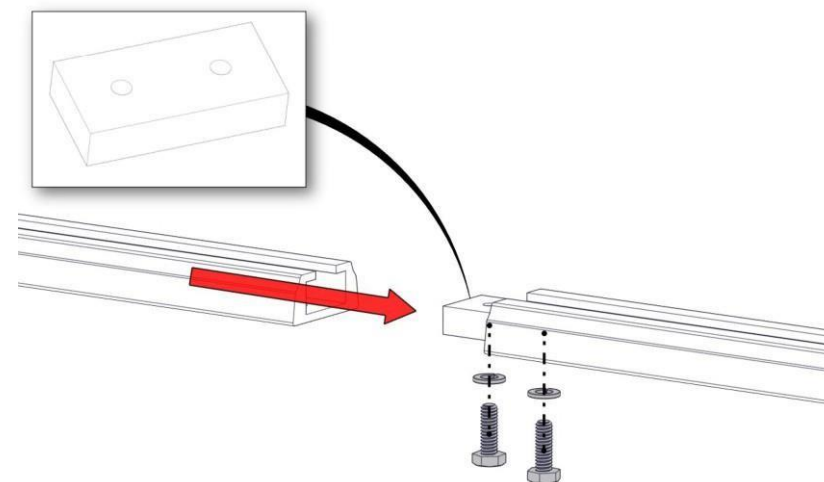

**Step 2.**

Slide joining block (02P125) into channels. Fasten with 1/4" lock washers and 1/4" X 1" hex bolts. Tighten with 7/16" wrench.

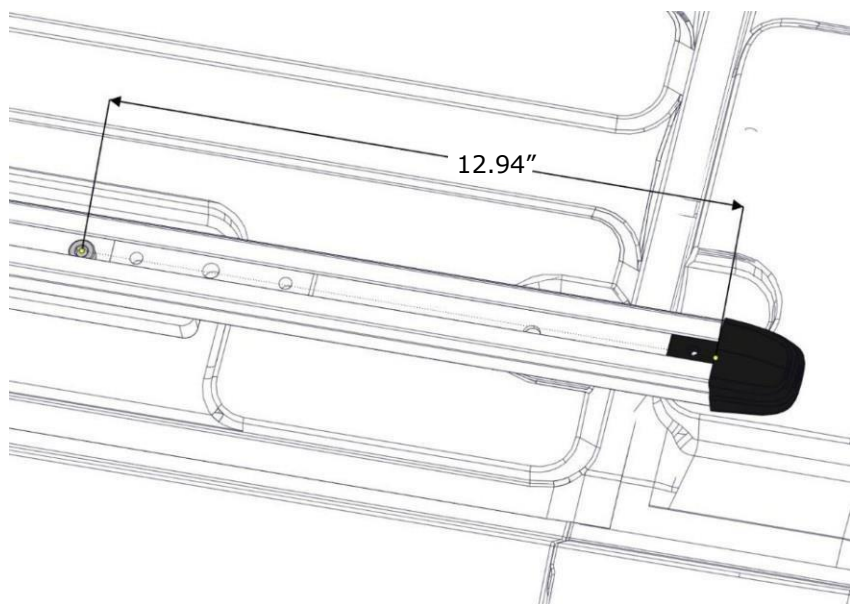

**Step 3. (130" Wheelbase)**

Starting with the rear bolt, use the 2nd hole from the end,  
Located approx. 13" from the end

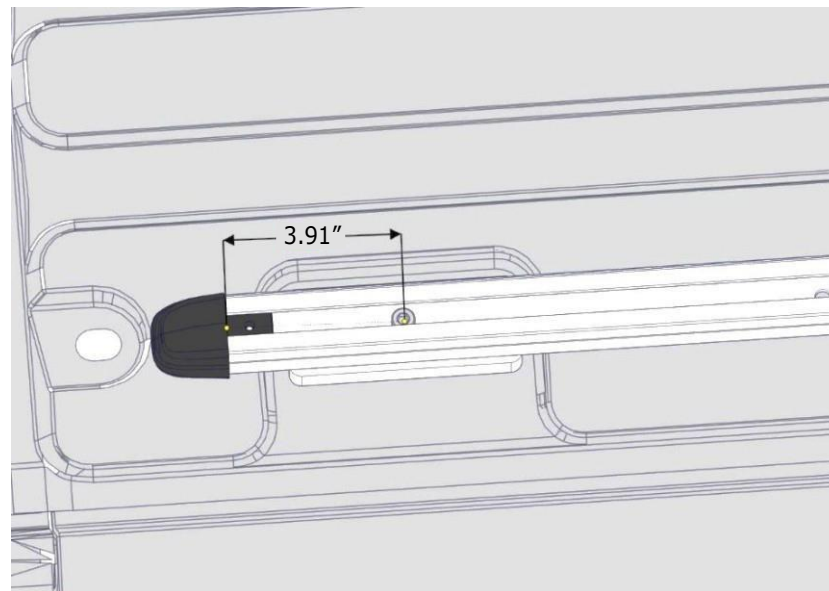

**Step 3. (148" Wheelbase)**

Starting with the rear bolt, use the 1<sup>st</sup> hole from the end, located  
approx. 4" from the end

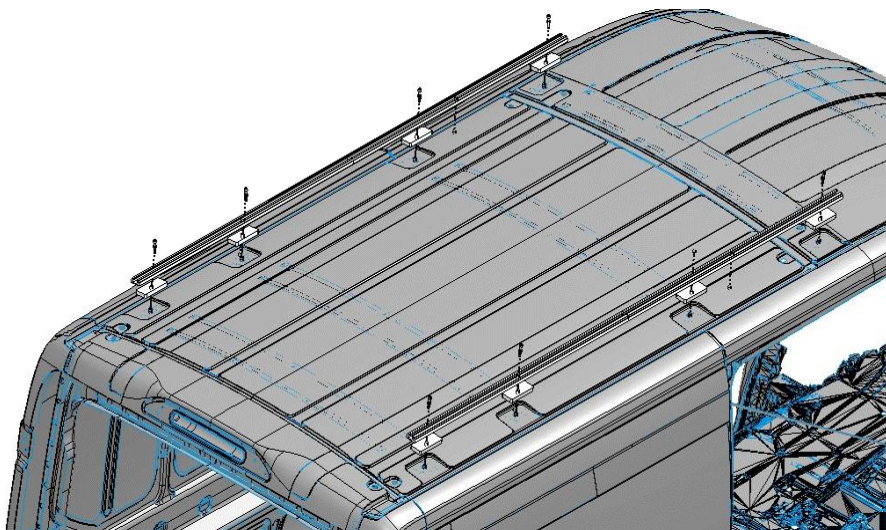

**Step 4.**

Fasten rails using 8 X 40MM socket cap screws (02P332) with nylon spacers (02P135) in between rail. Use the 6mm Allen wrench to tighten bolts.



**Step 5.**

Slide ladder stop (02P664) inside drop down, and tighten with 9/16 socket or wrench

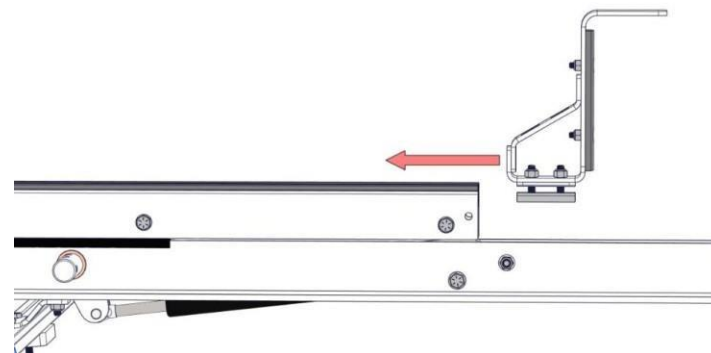

**Step 6.**

Slide ladder stop (02P664) tighten bolts using 9/16 socket or wrench

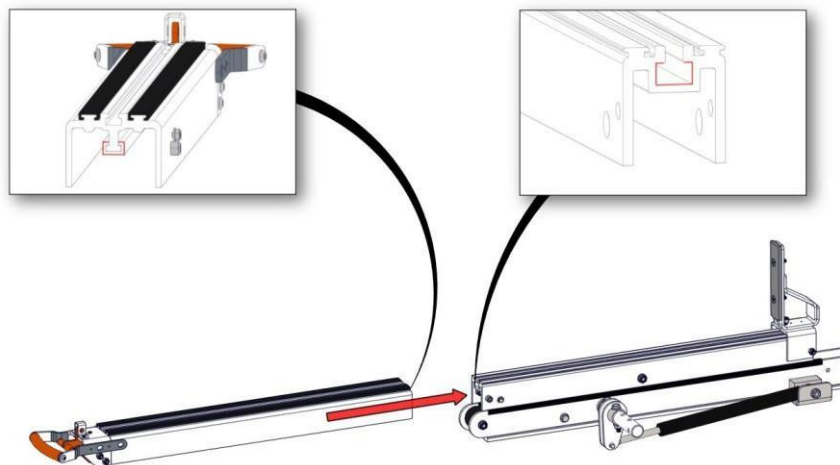

**Step 7.**

Slide the drop-down assembly onto the crossbow by lining up the extrusion and sliding into place.

## IMPORTANT TO NOTE:

A BLUE sticker indicates the REAR Crossbow (02P326)



A GREEN sticker indicates the FRONT Crossbow (02P675)





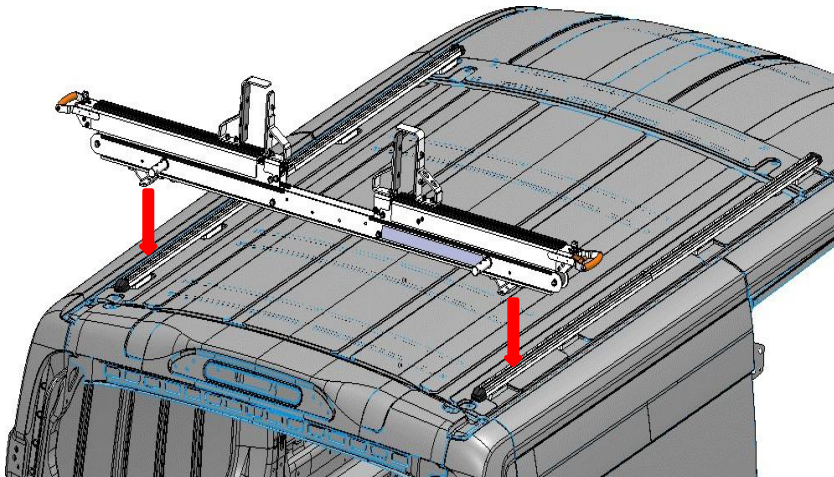

**Step 8.**  
Lay rear crossbow across mounting rails

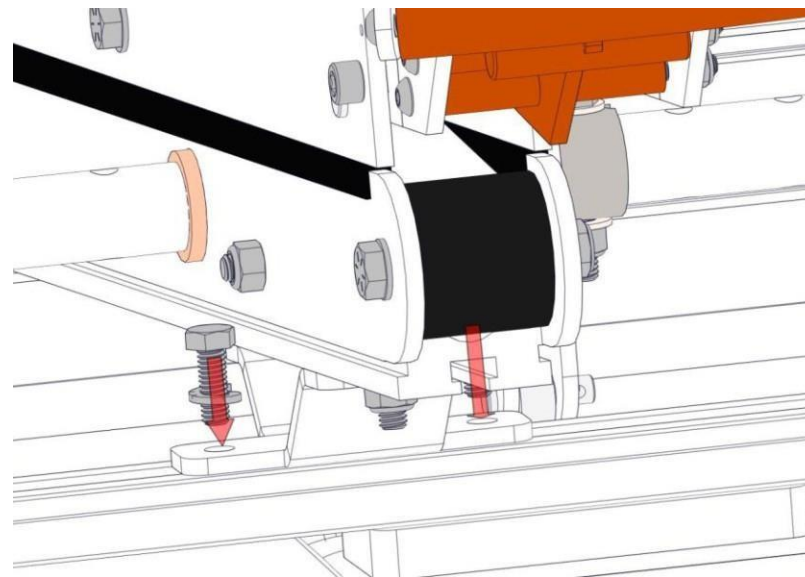

**Step 9.**  
Install 5/16 X 7/8 bolts (4) with lock washers (4) through crossbow mounts into receiver blocks and apply seize to bolts **Do not tighten**

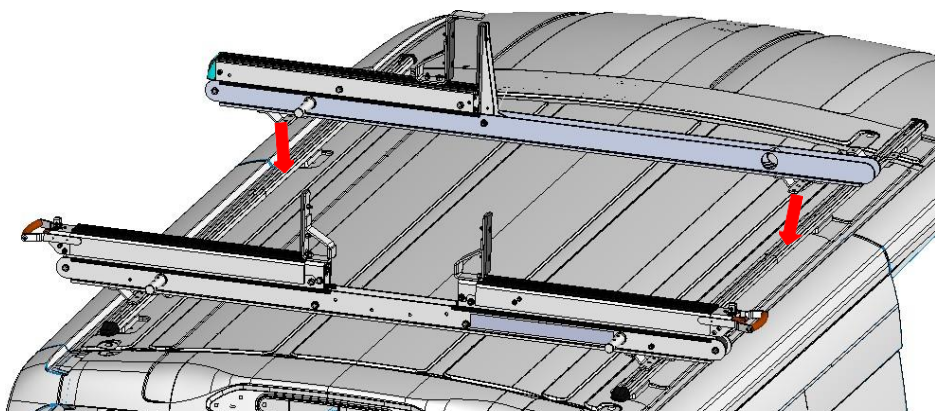

**Step 10.**  
Lay middle crossbow across mounting rails

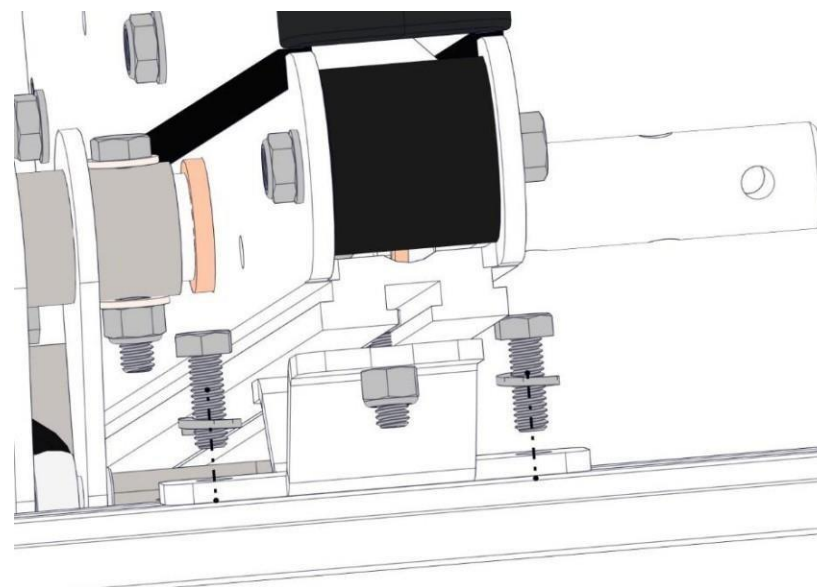

**Step 11.**  
Install 5/16 X 7/8 bolts (4) with lock washers (4) through crossbow mounts into receiver blocks and apply seize to bolts **Do not tighten**

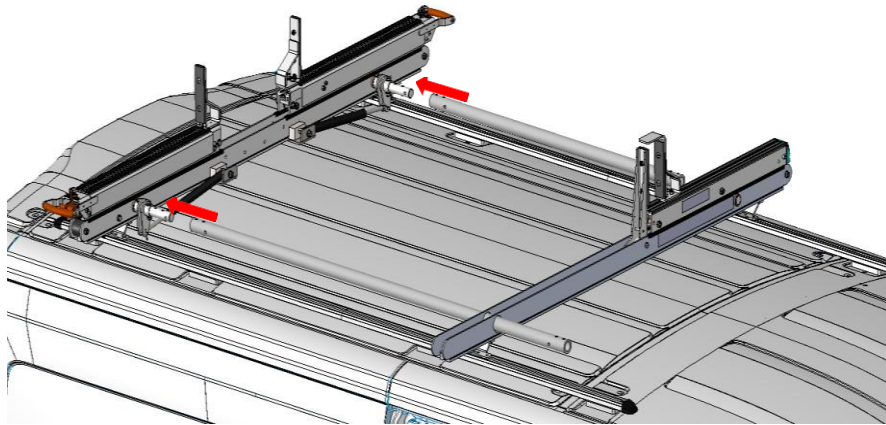

**Step 12.**

- Slide Connecting tubes (02P328) which moves through center crossbow to rear crossbow.
- Slide connecting tube (Short) between center and rear crossbow. Line holes up with crossbow rod and connecting tube

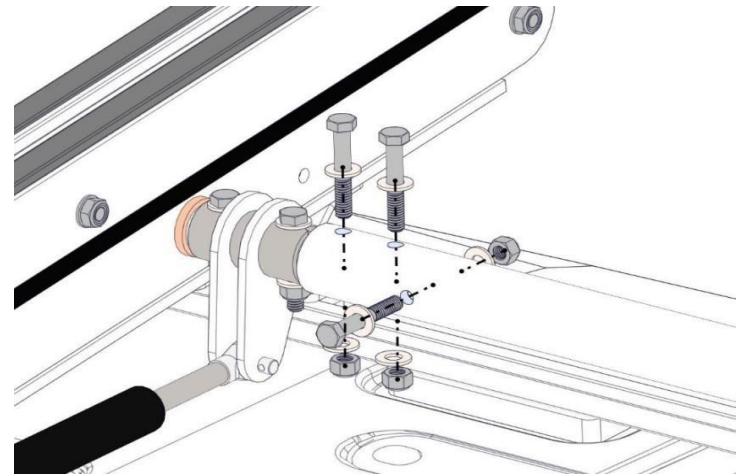

**Step 13.**

Install connecting tubes with 5/16" X 2 - 1/2" fasteners (6) & washers (12) and apply seize to bolts

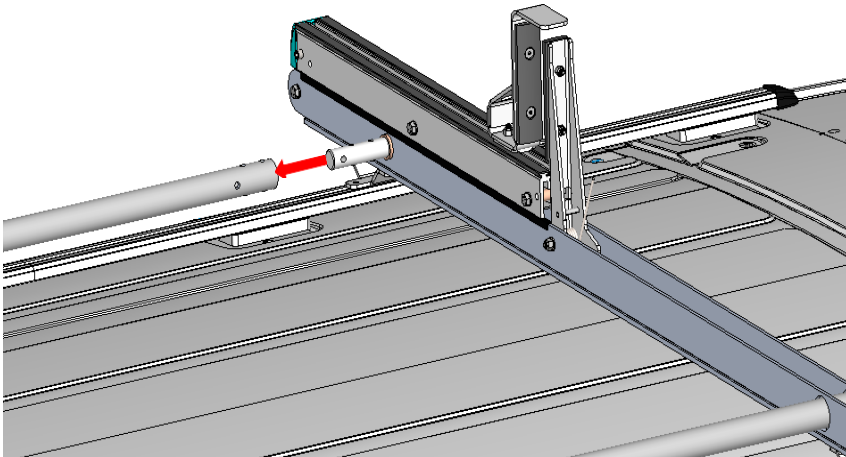

**Step 14.**

Slide middle crossbow into connecting tubes

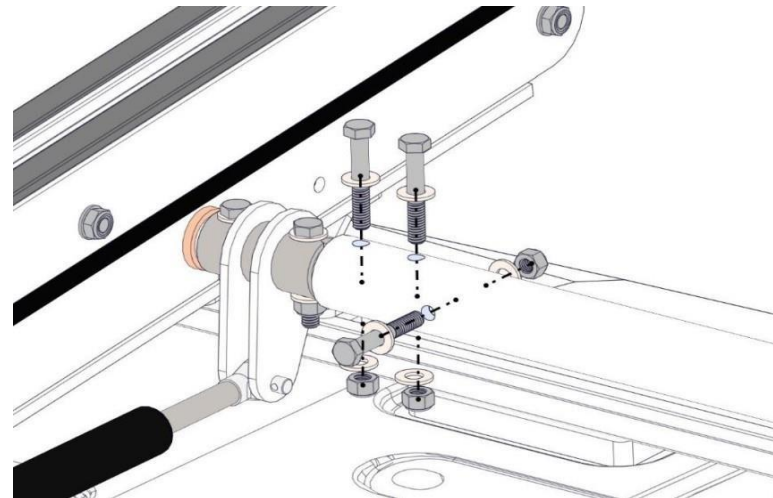

**Step 15.**

Install connecting tubes with 5/16" X 2 - 1/2" fasteners (9) & washers (18) and apply seize to bolts



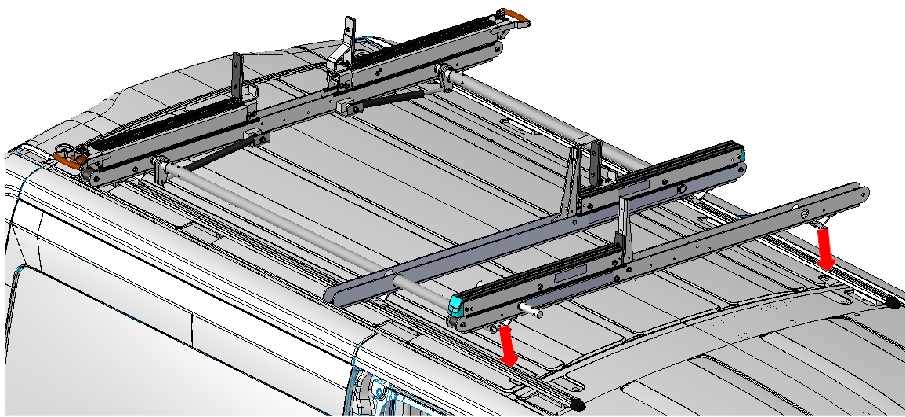

**Step 16.**

Lay front crossbow across mounting rail

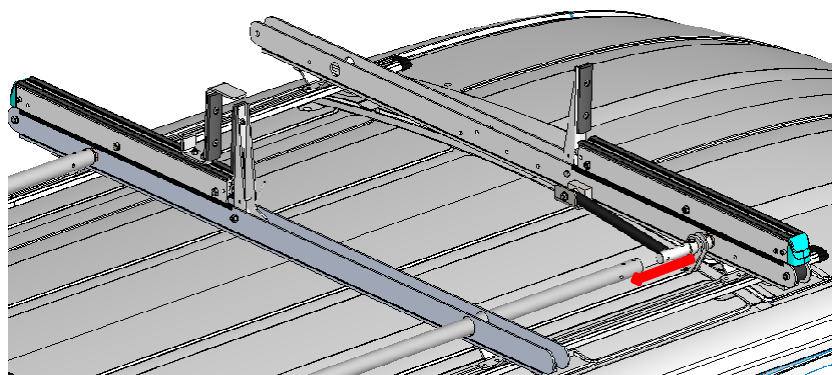

**Step 17.**

Slide front crossbow into connecting tubes

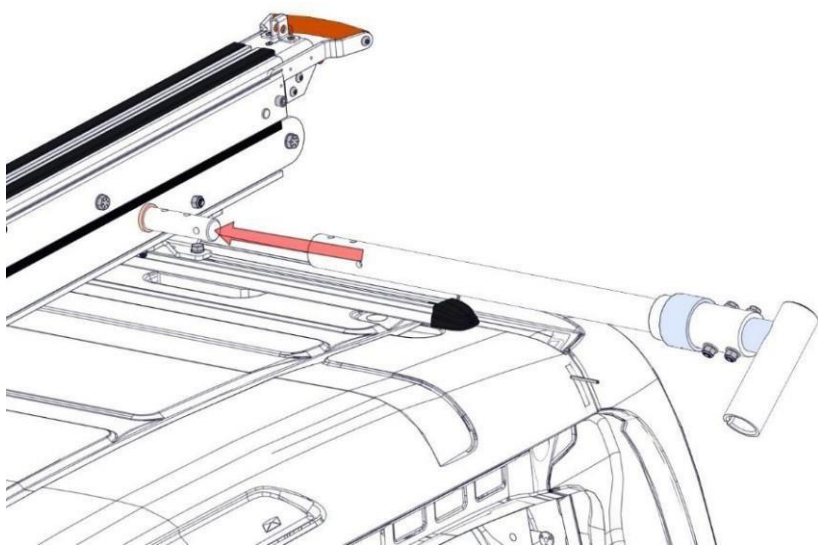

**Step 18.**

Install handle assembly into rear crossbow

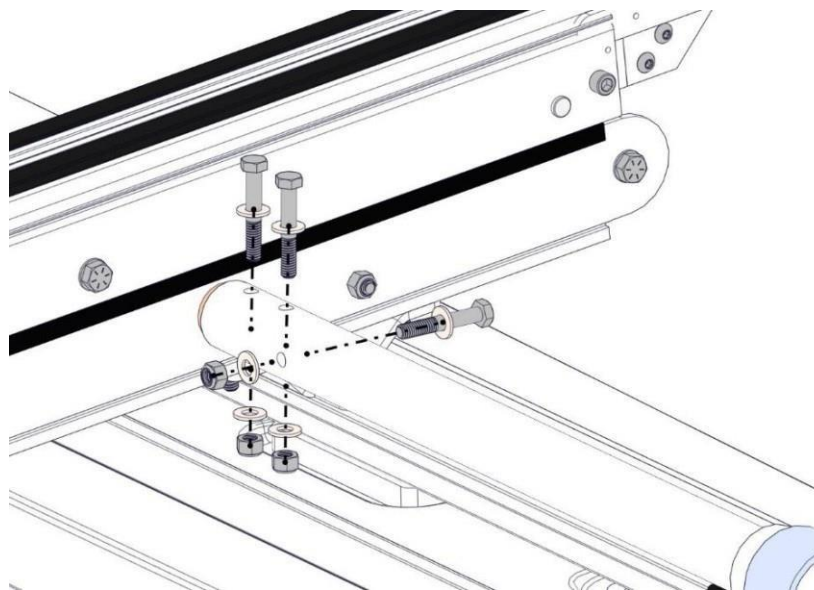

**Step 19.**

Fasten handle with 5/16 X 2-1/2 bolts (6) and washers (12) and apply seize to bolts

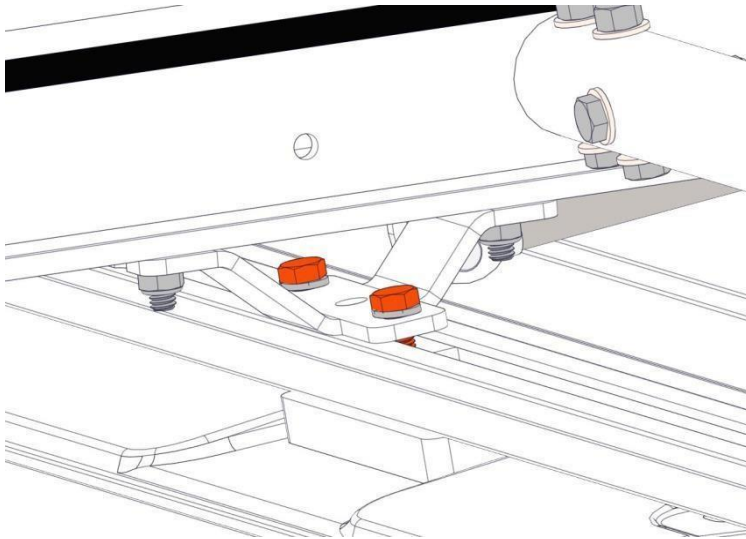

**Step 20.**

Tighten crossbow bolts

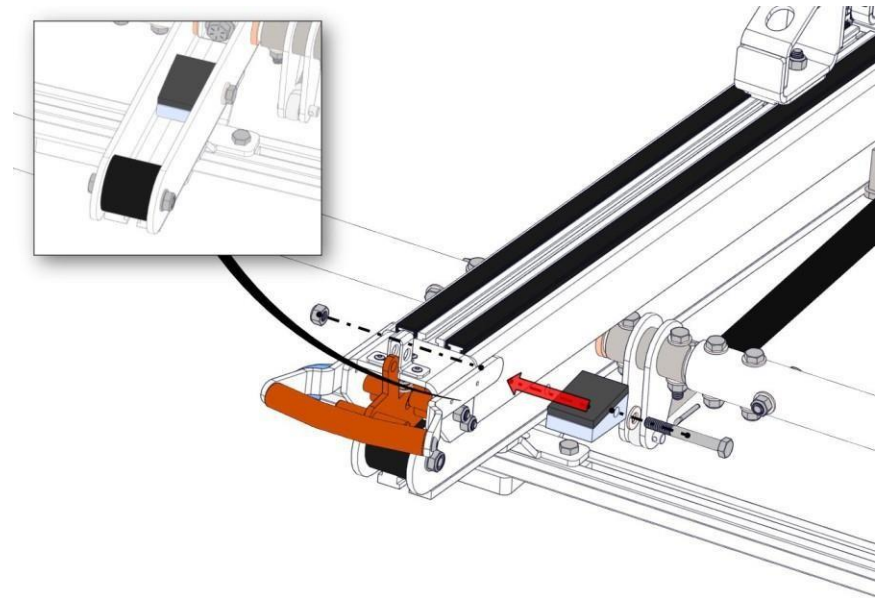

**Step 21.**

Install ladder stops (2) on curbside crossbows using 5/16" x 2-1/2" bolts, washer, bumper stop and nut and tighten with a 1/2" wrench