

Recommended Tools

Air or Hand Ratchet



1/2" Socket



7/16" Combo Wrench



1/2" Combo Wrench



6mm Hex Allen Wrench



PN	DESCRIPTION	QTY
02P325	CROSSBEAM ASSEMBLY UPLYFT	1
02P326	CROSSBOW ASSY - FRONT	1
02P328	CONNECTING TUBE	2
02P103	DROP DOWN ASSEMBLY	2
02P393	MIDROOF HANDLE ASSY	1
02P663	LADDER STOP ASSY FRONT	2
02P664	LADDER STOP ASSY REAR	2
02P665	ROTATION ASSEMBLY MR	2
02P666	HARDWARE BAG	1
02P112	MOUNTING RAIL	4
02P148	RAIL CAP UPLYFT	4
RM518016	SCREW PPHSM 14 X.625	4
02P673	HARDWARE BAG TRANSIT	1
02P756	UPLYFT TRANSIT SHIP PACK	1

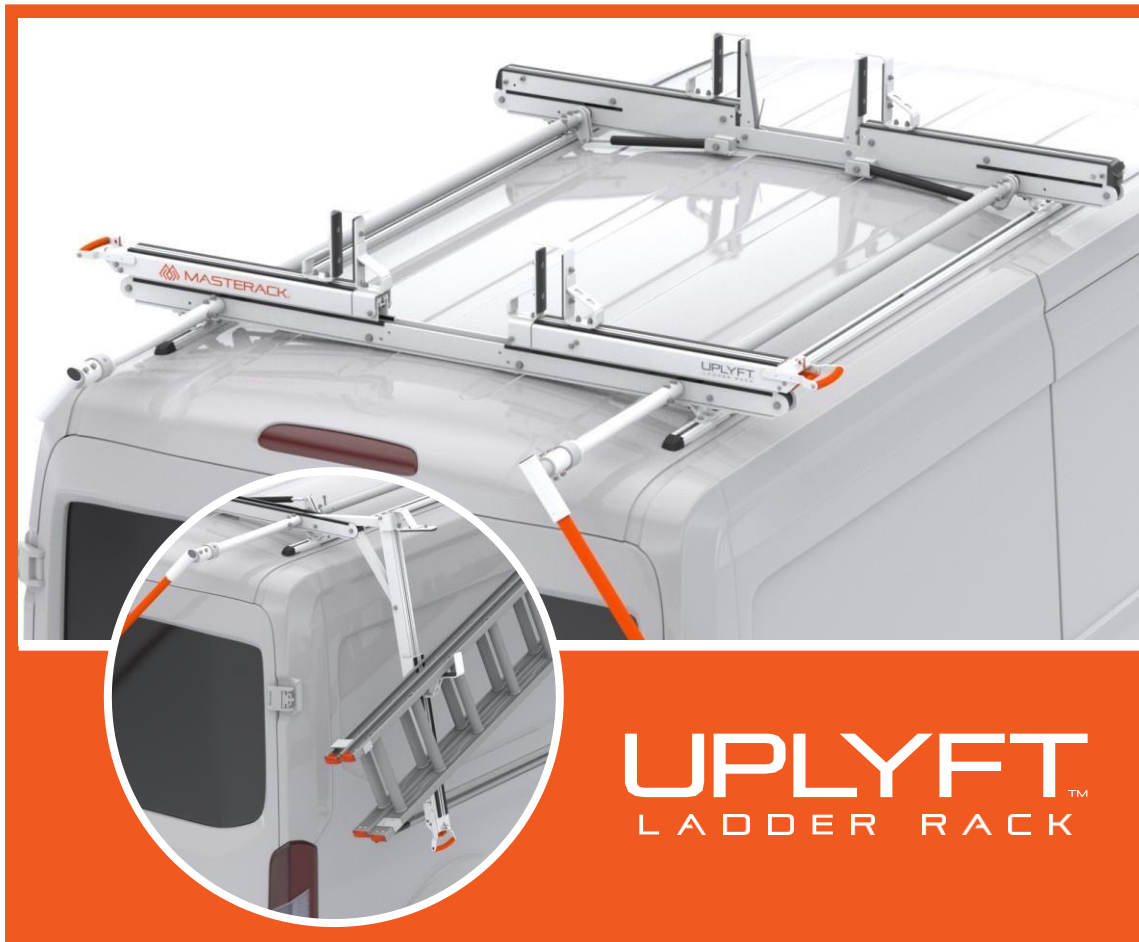

UPLYFT
LADDER RACK

UPLYFT™ LADDER RACK SYSTEM

Before installation, review this document to ensure that all parts and hardware are included in the package.
In the event that parts are missing, please contact Masterack at 1-800-222-8785 to re-order missing parts.

BEFORE INSTALLATION PLEASE REVIEW THIS ENTIRE DOCUMENT, UNTIL YOU ARE COMPLETELY FAMILIAR WITH ALL STEPS BEFORE BEGINNING. A "PRACTICE RUN" OF THESE STEPS/PROCEDURES MAY BE HELPFUL TO ASSIST YOU IN FAMILIARIZING YOURSELF THOROUGHLY AND AVOID COSTLY ERRORS.

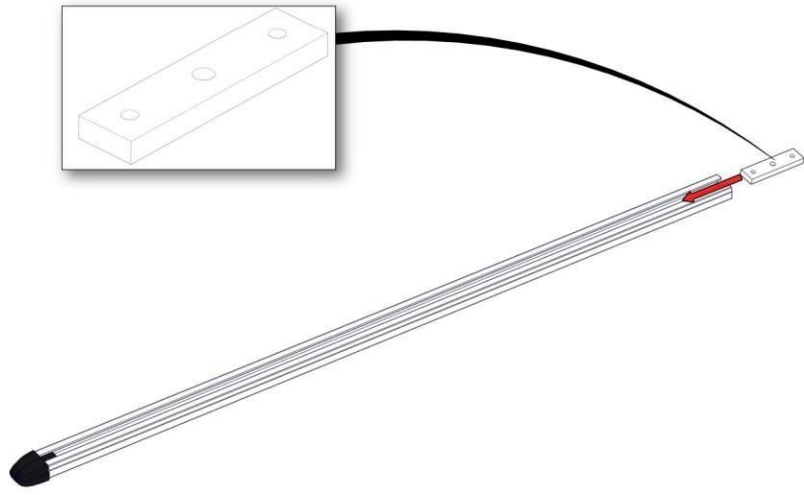

Step 1.
Slide receiver block (02P118) into each of the 4 mounting rails (02P112)

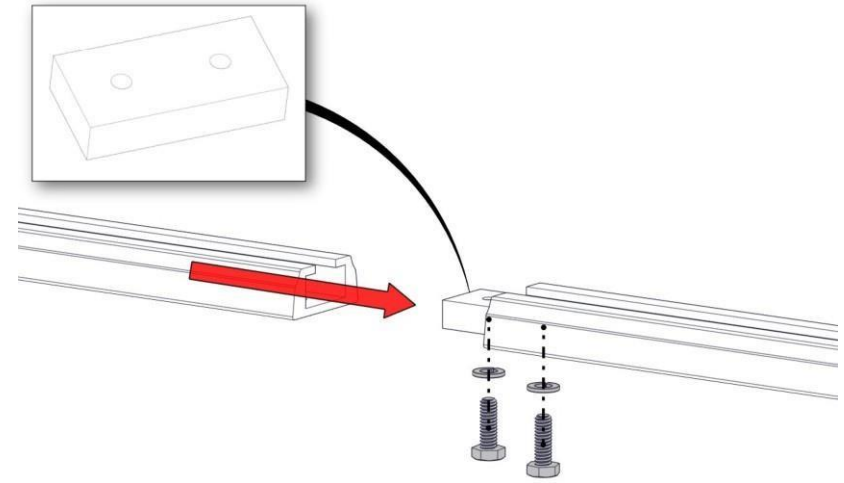

Step 2.
Slide joining block (02P125) into channels. Fasten with 1/4" lock washers and 1/4" X 1" hex bolts. Tighten with 7/16" wrench.

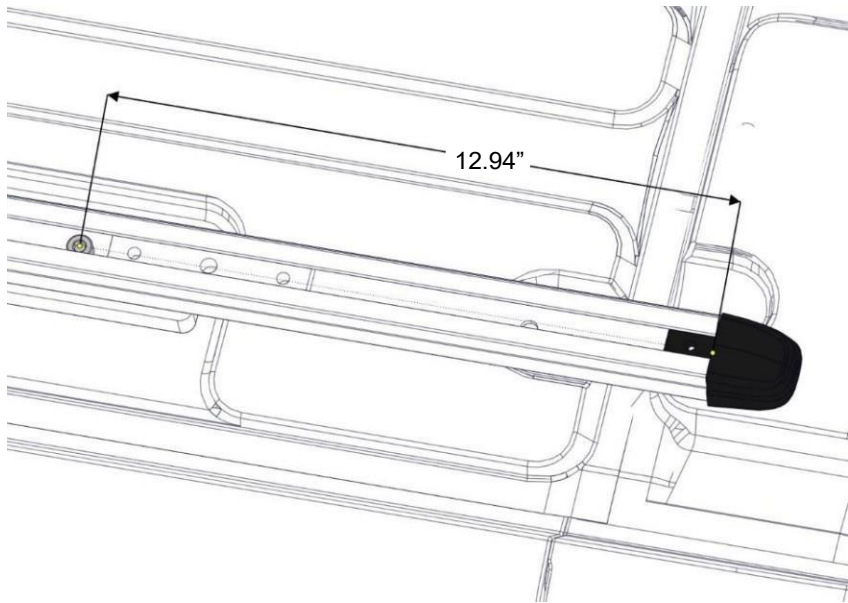

Step 3. (130" Wheel Base)
Starting with the rear bolt, use the 2nd hole from the end,
Located approx. 13" from the end

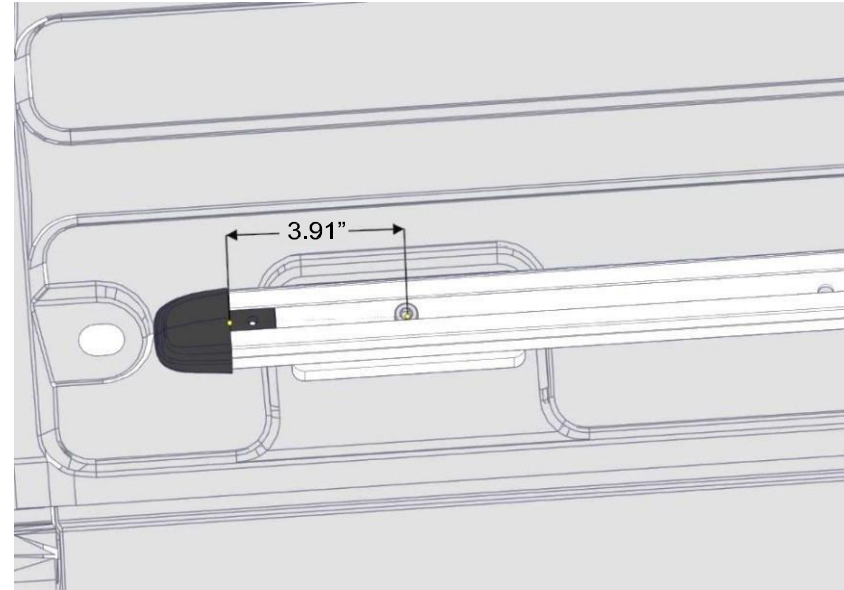

Step 3. (148" Wheel Base)
Starting with the rear bolt, use the 1st hole from the end, located
approx. 4" from the end

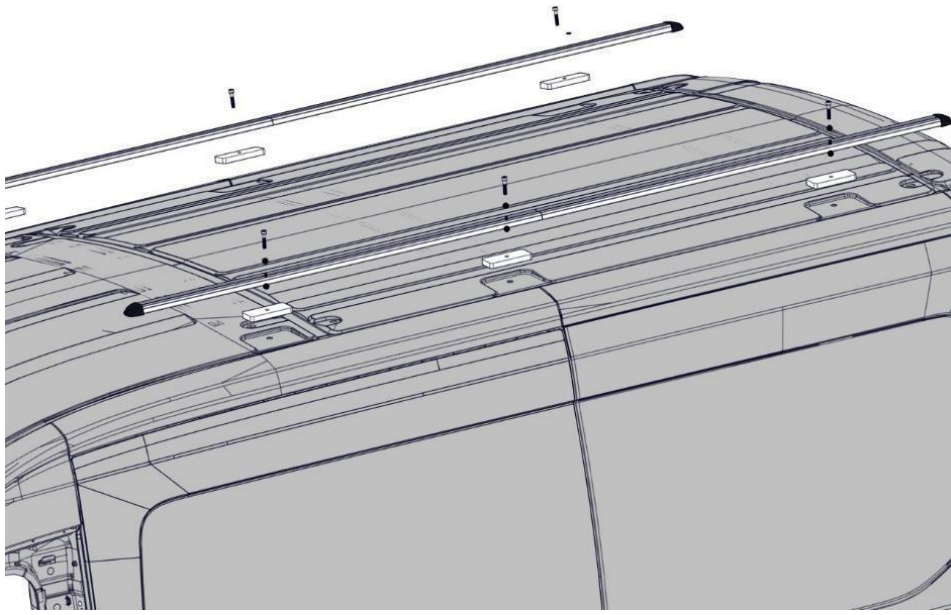

Step 4.
Fasten rails using 8 X 40MM socket cap screws (02P332) with nylon spacers (02P135) in between rail. Use the 6mm Allen wrench to tighten bolts.



Step 5.
Slide ladder stop (02P663) inside drop down, and tighten with 9/16 socket or wrench

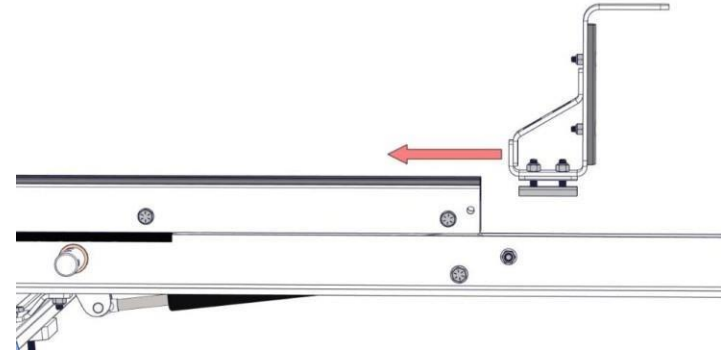

Step 6.
Slide ladder stop (02P664) tighten bolts using 9/16 socket or wrench

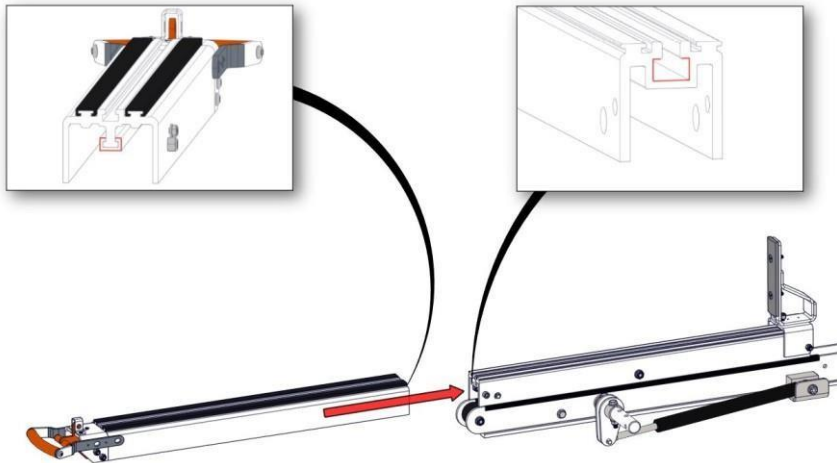

Step 7.
Slide the drop down assembly onto the crossbow by lining up the extrusion and sliding into place.

IMPORTANT TO NOTE:

A BLUE sticker indicates the FRONT Crossbow (02P326)



A GREEN sticker indicates the REAR Crossbow (02P325)



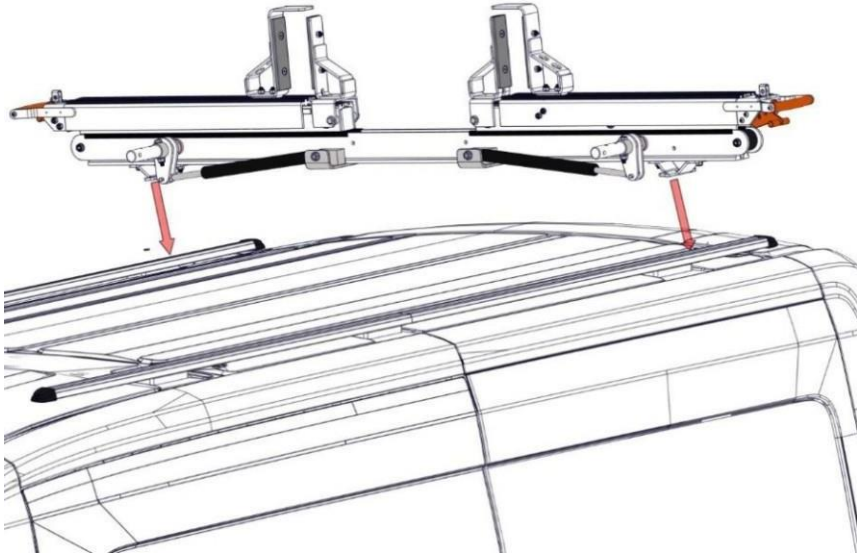

Step 8.
Lay rear crossbow across mounting rails.

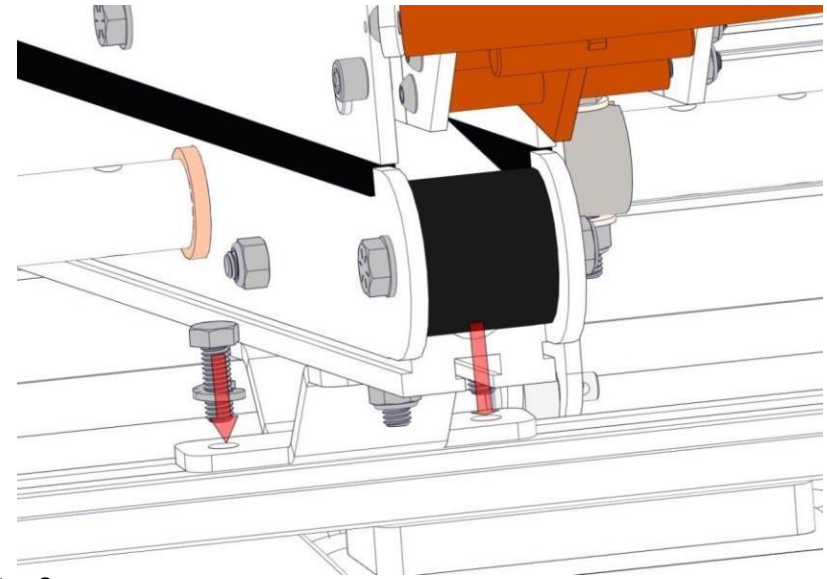

Step 9.
Install 5/16 X 7/8 bolts (4) with lock washers (4) through crossbow mounts into receiver blocks and apply seize to bolts **Do not tighten**

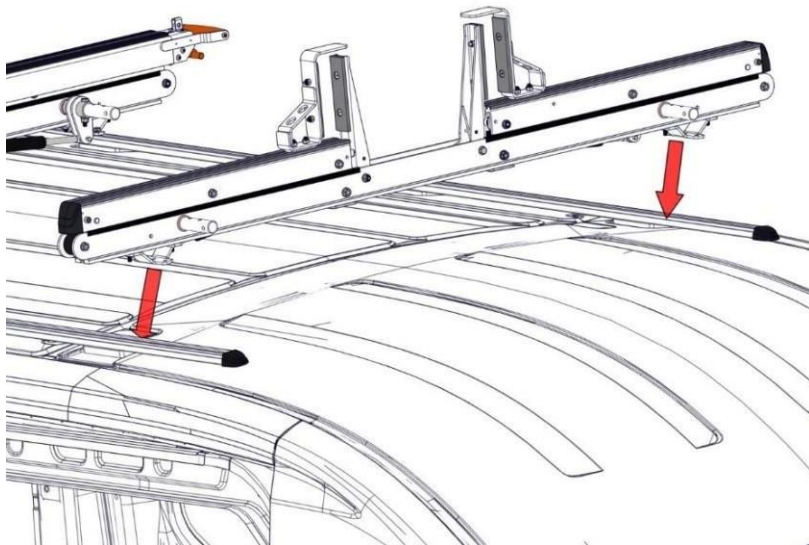

Step 10.
Lay front crossbow across mounting rails

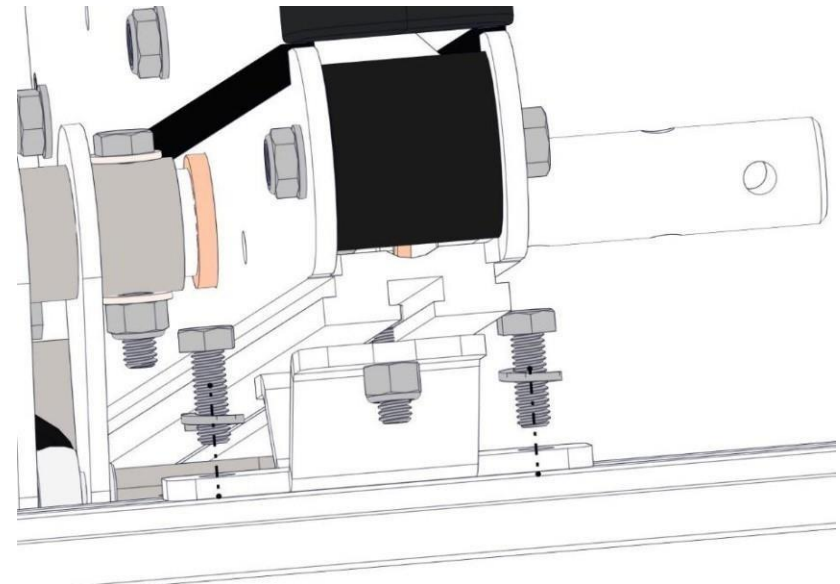

Step 11.
Install 5/16 X 7/8 bolts (4) with lock washers (4) through crossbow mounts into receiver blocks and apply seize to bolts **Do not tighten**

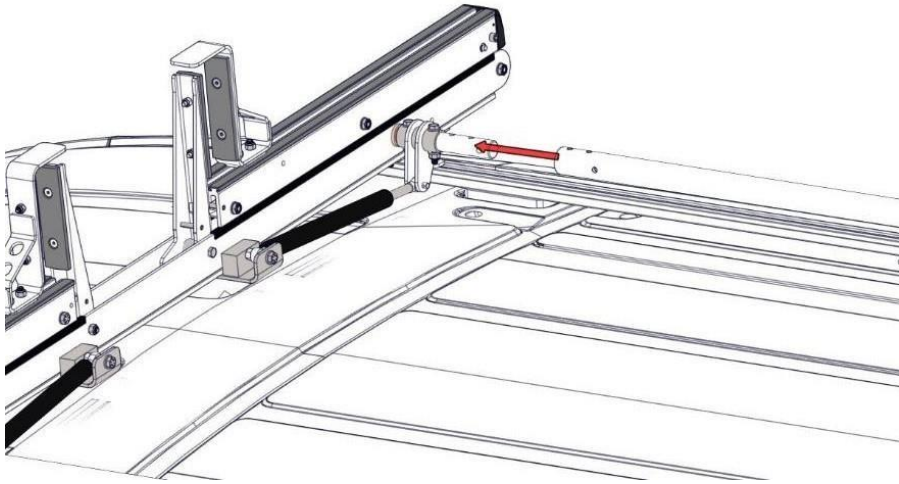

Step 12.
Slide Connecting tubes (02P328) into front crossbow. Line holes up with crossbow rod and connecting tube

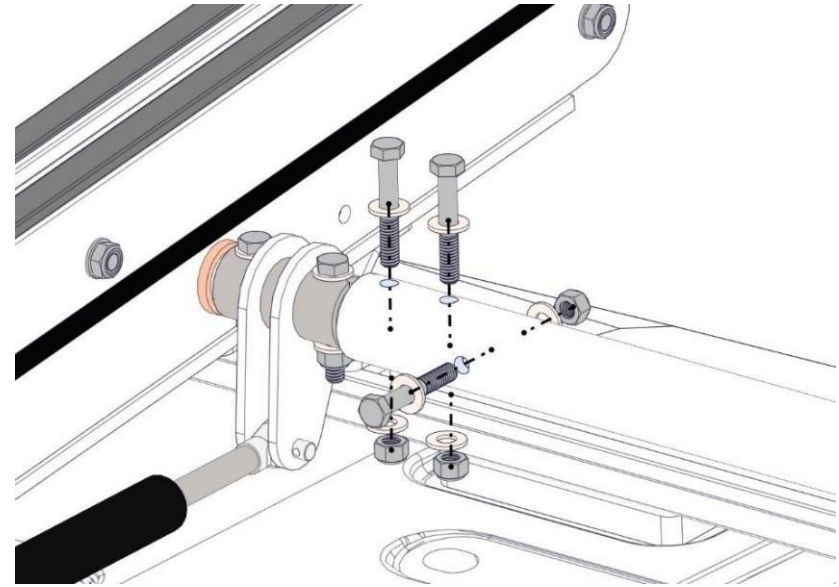

Step 13.
Install connecting tubes with 5/16" X 2 - 1/2" fasteners (6) & washers (12) and apply seize to bolts

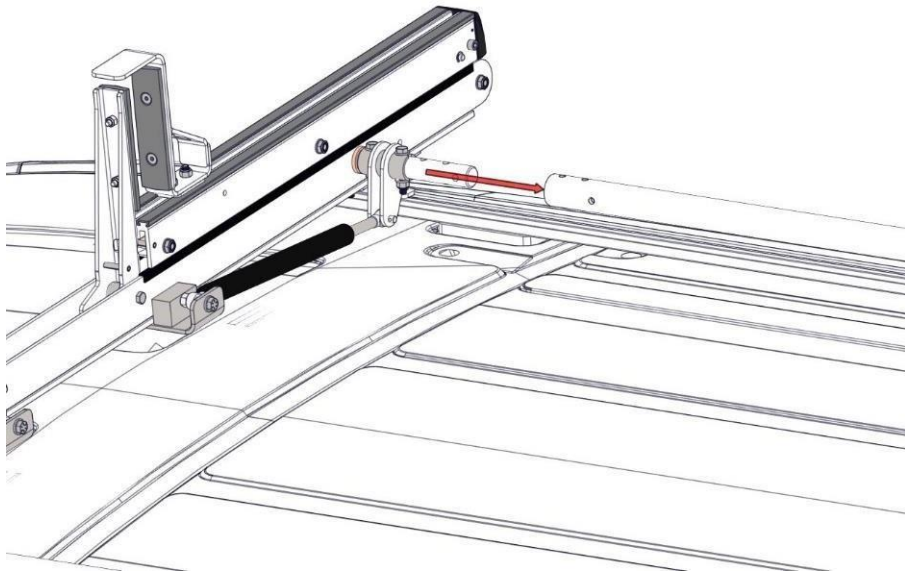

Step 14.
Slide rear crossbow into connecting tubes

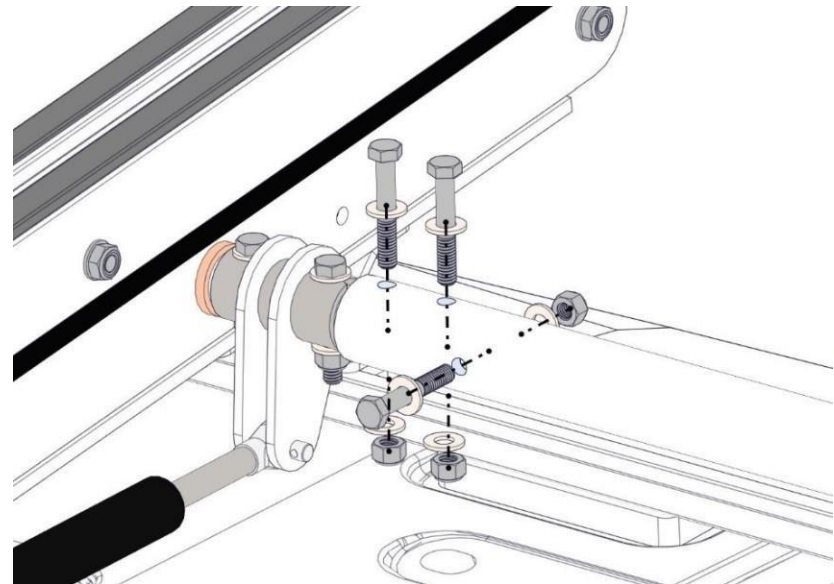

Step 15.
Install connecting tubes with 5/16" X 2 - 1/2" fasteners (6) & washers (12) and apply seize to bolts

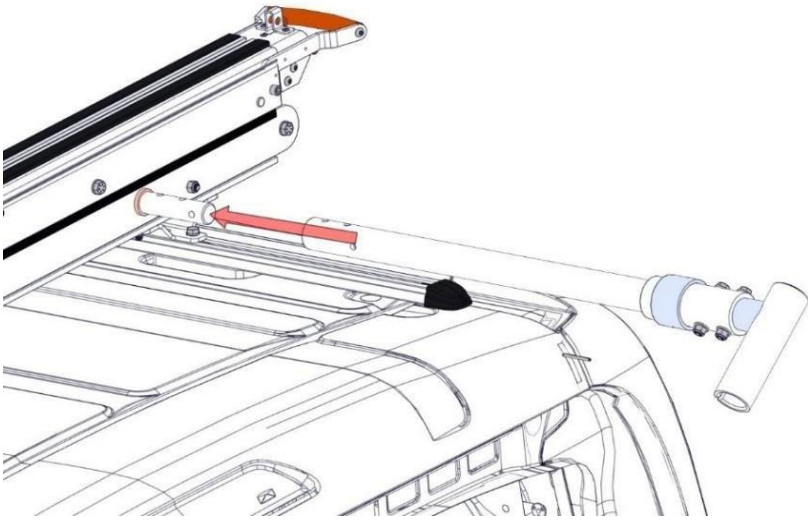

Step 16.
Install handle assembly into rear crossbow

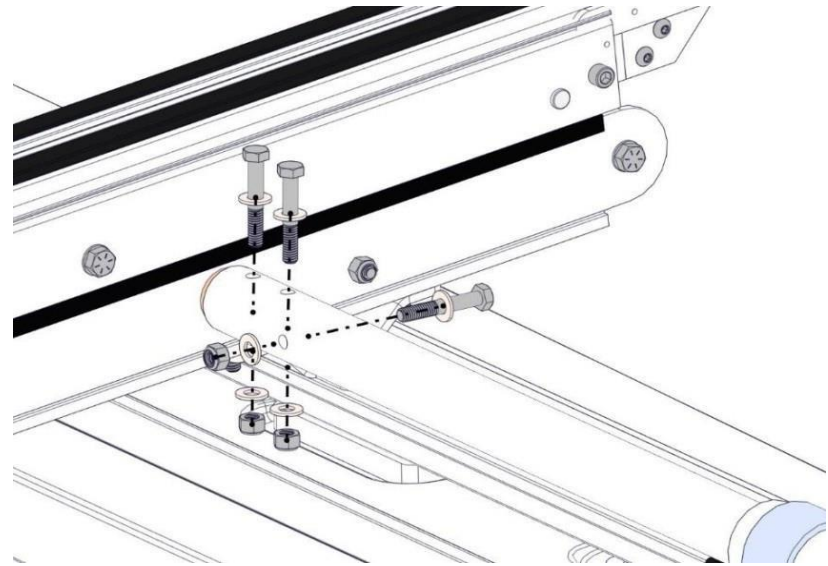

Step 17.
Fasten handle with 5/16 X 2-1/2 bolts (6) and washers (12) and apply seize to bolts

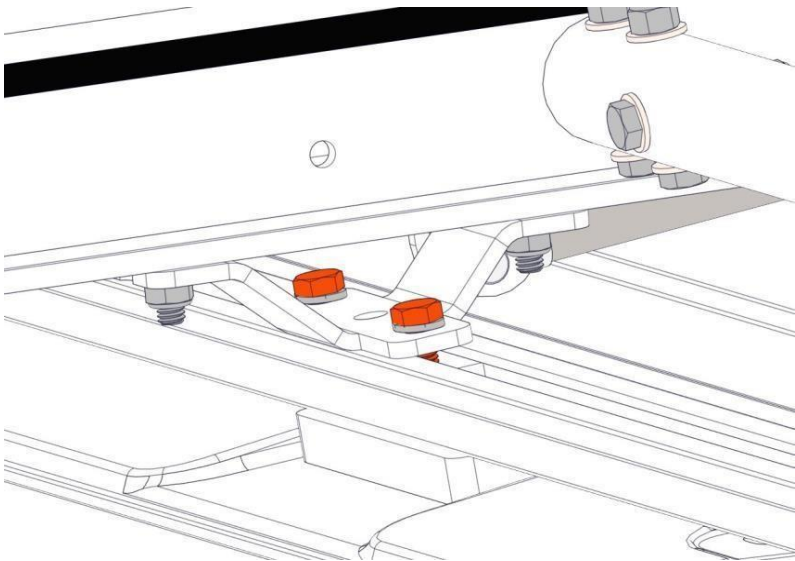

Step 18.
Tighten crossbow bolts

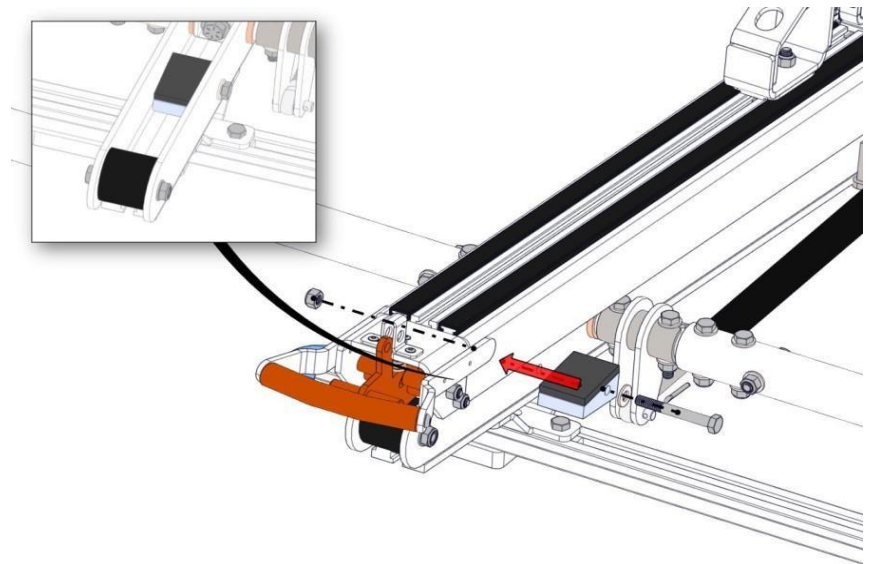

Step 19.
Install ladder stops (2) on curbside crossbows using 5/16" x 2-1/2" bolts, washer, bumper stop and nut and tighten with a 1/2" wrench