



Before starting installation, review this document to ensure that all parts and hardware are included in the package.

**In the event that parts are missing, please contact MASTERACK at 1-800-222-8785 to re-order missing parts.**

## Tapered Modules Assembly / Installation Instructions



**MASTERACK.COM**

MASTERACK Headquarters  
2400 Mellon Court  
Decatur, GA 30035  
800-222-8785

## ■ Parts Cabinet With Dividers

See page 5 for specific module.

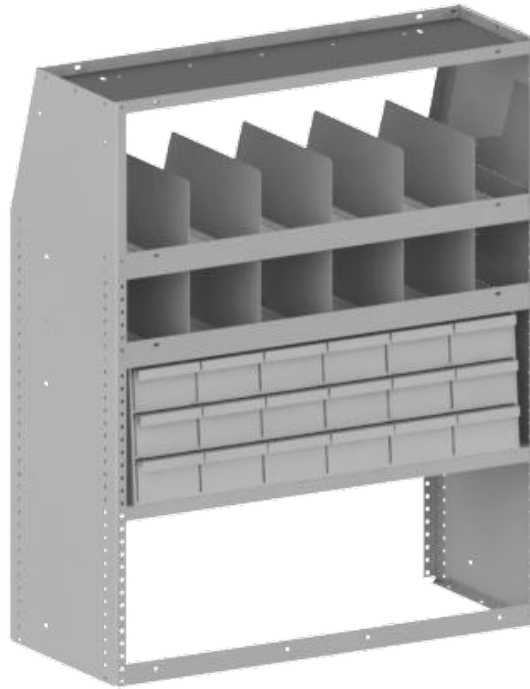

## ■ Recommended Tools

**Air or Hand Ratchet**

**Combo Wrench**  
[7/16"]

**Torque Wrench**

**Sockets**  
[7/16"]



## ■ Hardware

  
1/4-20 x 3/4  
Hex Head Screw

  
1/4-20 x 2 1/2  
Hex Head Screw Grd 8  
(USED WITH PLUSNUT TOOL)

  
1/4-20 x 1 1/4  
Hex Head Screw

  
1/4-20  
E-Stop Nut

  
#SRT25PB280  
PRE-BULB PLUSNUT

  
#C500-25  
PLUSNUT TOOL

  
Collar  
1" OD x .375 THK

  
1/4  
Lock washer

  
1/4-20  
Flat washer

  
1/4-20  
Fender washer

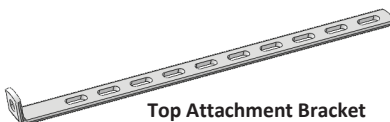
  
Top Attachment Bracket



Before starting installation, review this document to ensure that all parts and hardware are included in the package.

**In the event that parts are missing, please contact MASTERACK at 1-800-222-8785 to re-order missing parts.**

■ Exploded View

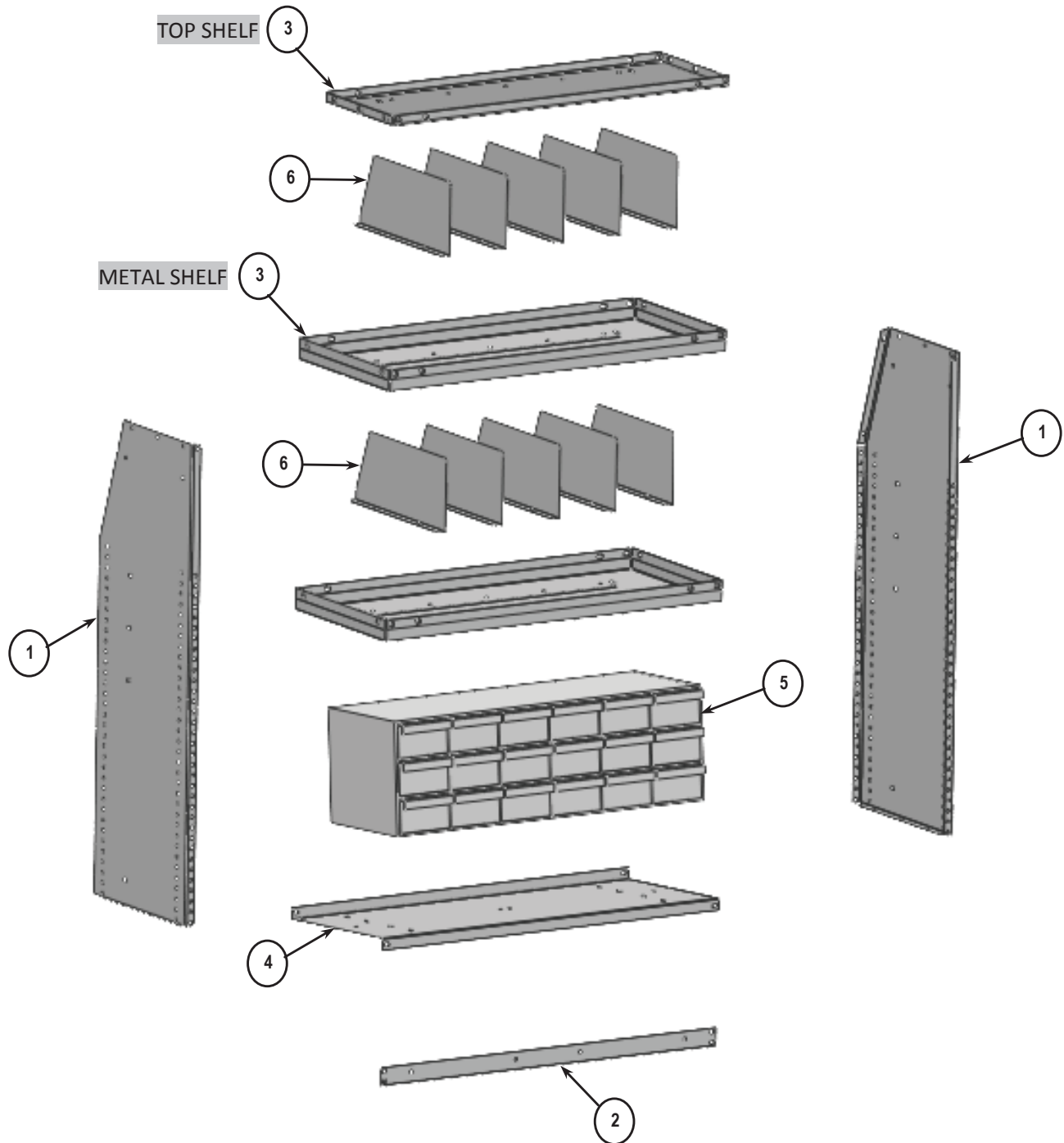

■ **Components**

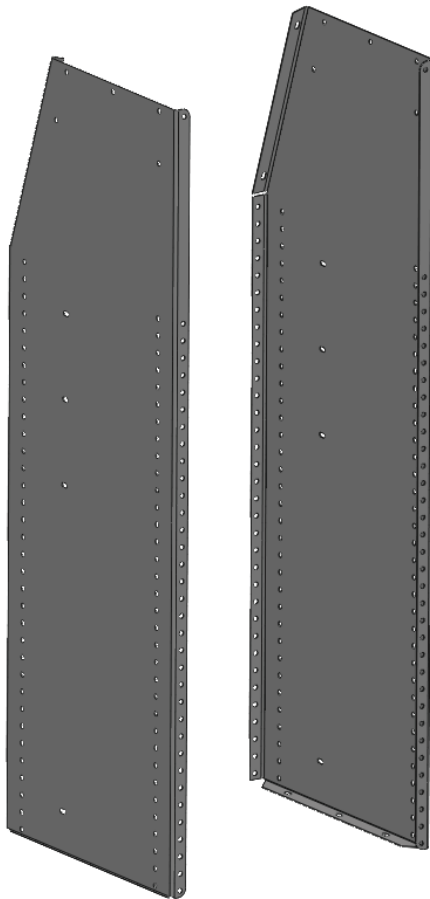

**1** TAPERED UPRIGHT (SET OF 2)

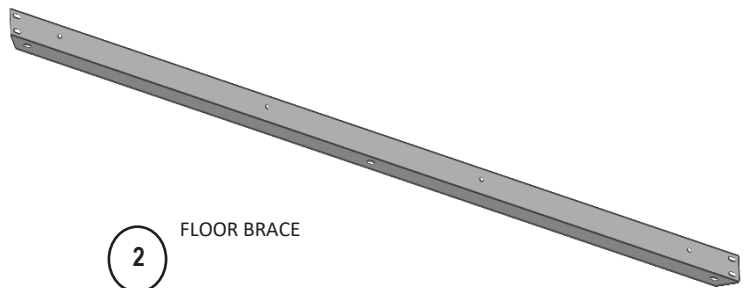

**2** FLOOR BRACE

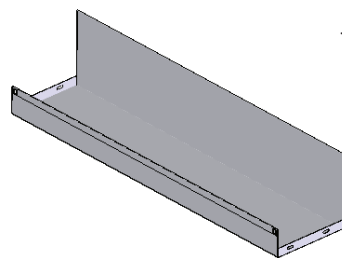

TOOL DROP TRAY  
SHOWN HERE

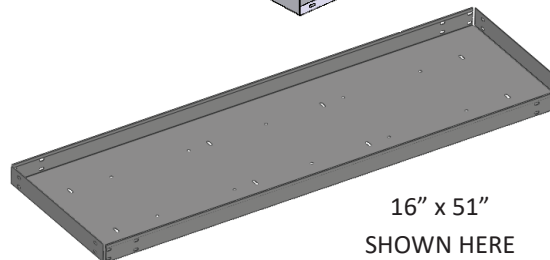

16" x 51"  
SHOWN HERE

**3** METAL SHELF

**Modules**
**1**
**2**
**3**
**4**

| Shelving Module | Uprights (L /R Set) | Floor Brace | Metal Shelf | Tool Drop Tray |
|-----------------|---------------------|-------------|-------------|----------------|
|-----------------|---------------------|-------------|-------------|----------------|

**46 Inch Tall Modules**

|                            |        |        |  |        |
|----------------------------|--------|--------|--|--------|
| 027545KP [46H x 37W x 12D] | 027167 | 023058 | 021381 – QTY. 2                          | 027165 |
| 027546KP [46H x 43W x 12D] | 027167 | 023059 | 021382 – QTY. 2                          | 027792 |
| 027538KP [46H x 19W x 16D] | 022395 | 023055 | 021378 –<br>TOP SHELF<br>025153 – QTY. 3 |        |
| 022817KP [46H x 25W x 16D] | 022395 | 023056 | 021379 –<br>TOP SHELF<br>022816 – QTY. 3 |        |
| 022432KP [46H x 31W x 16D] | 022395 | 023057 | 021380 –<br>TOP SHELF<br>022398 – QTY. 3 |        |
| 022433KP [46H x 37W x 16D] | 022395 | 023058 | 021381 –<br>TOP SHELF<br>022397 – QTY. 3 |        |
| 022434KP [46H x 43W x 16D] | 022395 | 023059 | 021382 –<br>TOP SHELF<br>022396 – QTY. 3 |        |
| 025591KP [46H x 43W x 16D] | 022395 | 025680 | 025572 –<br>TOP SHELF<br>025571 – QTY. 3 |        |

**60 Inch Tall Modules**

|                            |        |        |  |  |
|----------------------------|--------|--------|--|--|
| 02A380KP [60H x 25W x 16D] | 02A355 | 023056 | 021379 –<br>TOP SHELF<br>022816 – QTY. 4 |  |
| 02A381KP [60H x 31W x 16D] | 02A355 | 023057 | 021380 –<br>TOP SHELF<br>022398 – QTY. 4 |  |
| 02A382KP [60H x 37W x 16D] | 02A355 | 023058 | 021381 –<br>TOP SHELF<br>022397 – QTY. 4 |  |
| 02A383KP [60H x 43W x 16D] | 02A355 | 023059 | 021382 –<br>TOP SHELF<br>022396 – QTY. 4 |  |
| 02A384KP [60H x 51W x 16D] | 02A355 | 023080 | 025572 –<br>TOP SHELF<br>025571 – QTY. 4 |  |

■ **Attaching Floor Brace**

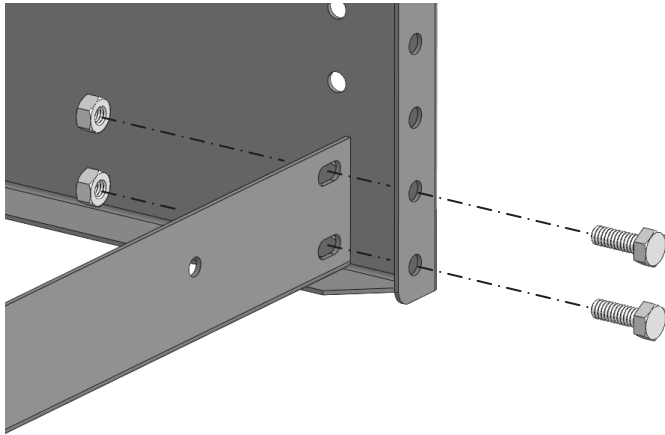

Attach as shown using:  
(4) 1/4-20 x 3/4 Hex Head Screws  
(4) 1/4-20 E-Stop Nuts

**TORQUE SETTING: Size - 1/4 = 7 - 9.5 Ft. Lbs.**

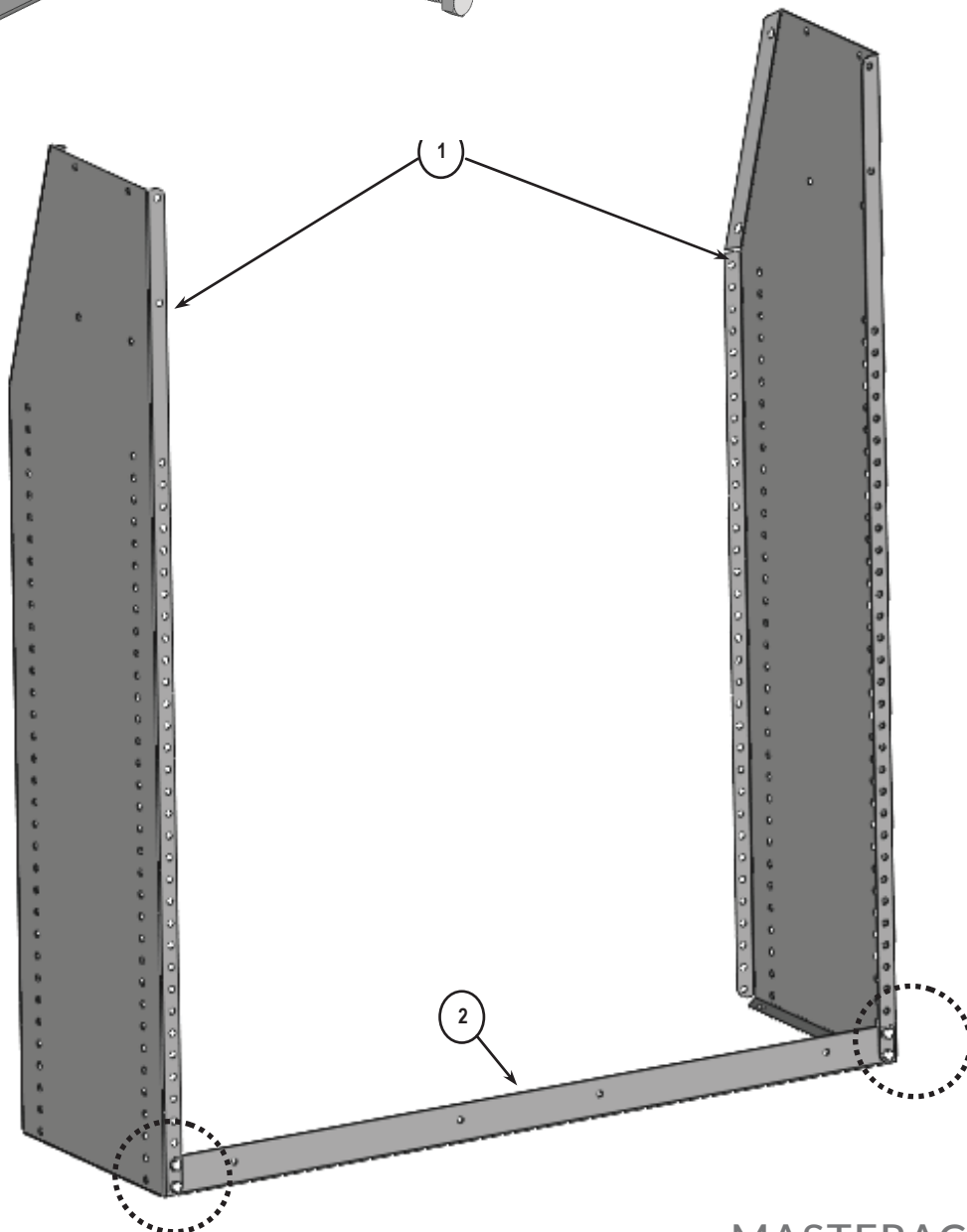

## ■ Attaching Bottom Shelf

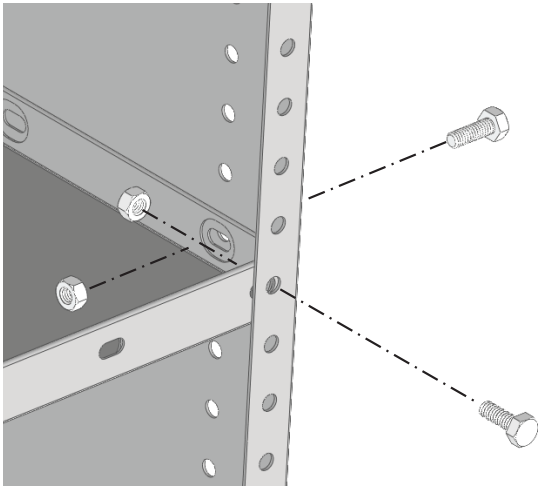

Attach Shelf as shown, using:  
(8) 1/4-20 x 3/4 Hex Head Screws  
(8) 1/4-20 E-Stop Nuts

**TORQUE SETTING: Size - 1/4 = 7 - 9.5 Ft. Lbs.**

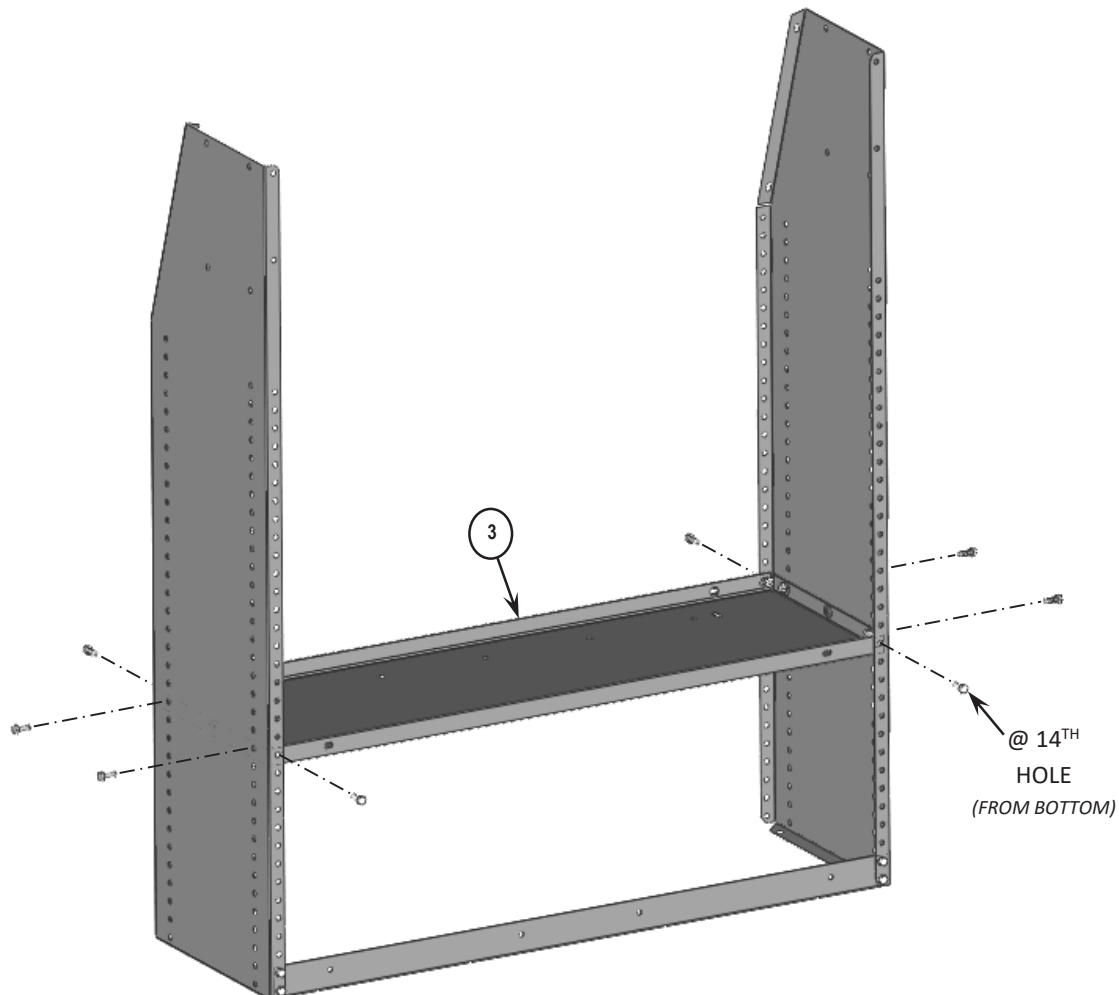

■ **Attaching Bottom Shelf - Applicable  
With Heavy Duty Shelves**

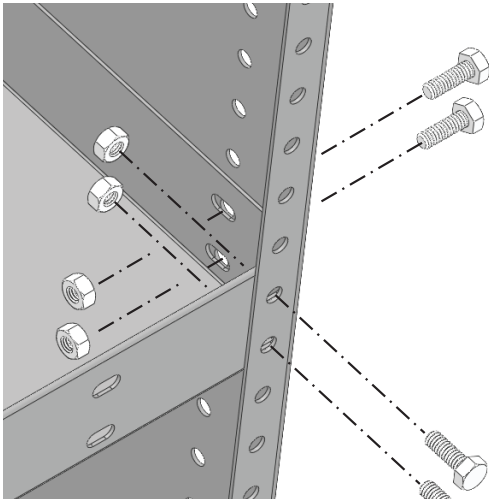

Attach Heavy Duty Shelves as shown, using:  
(16) 1/4-20 x 3/4 Hex Head Screws  
(16) 1/4-20 E-Stop Nuts  
**PER SHELF**

**TORQUE SETTING: Size - 1/4 = 7 - 9.5 Ft. Lbs.**

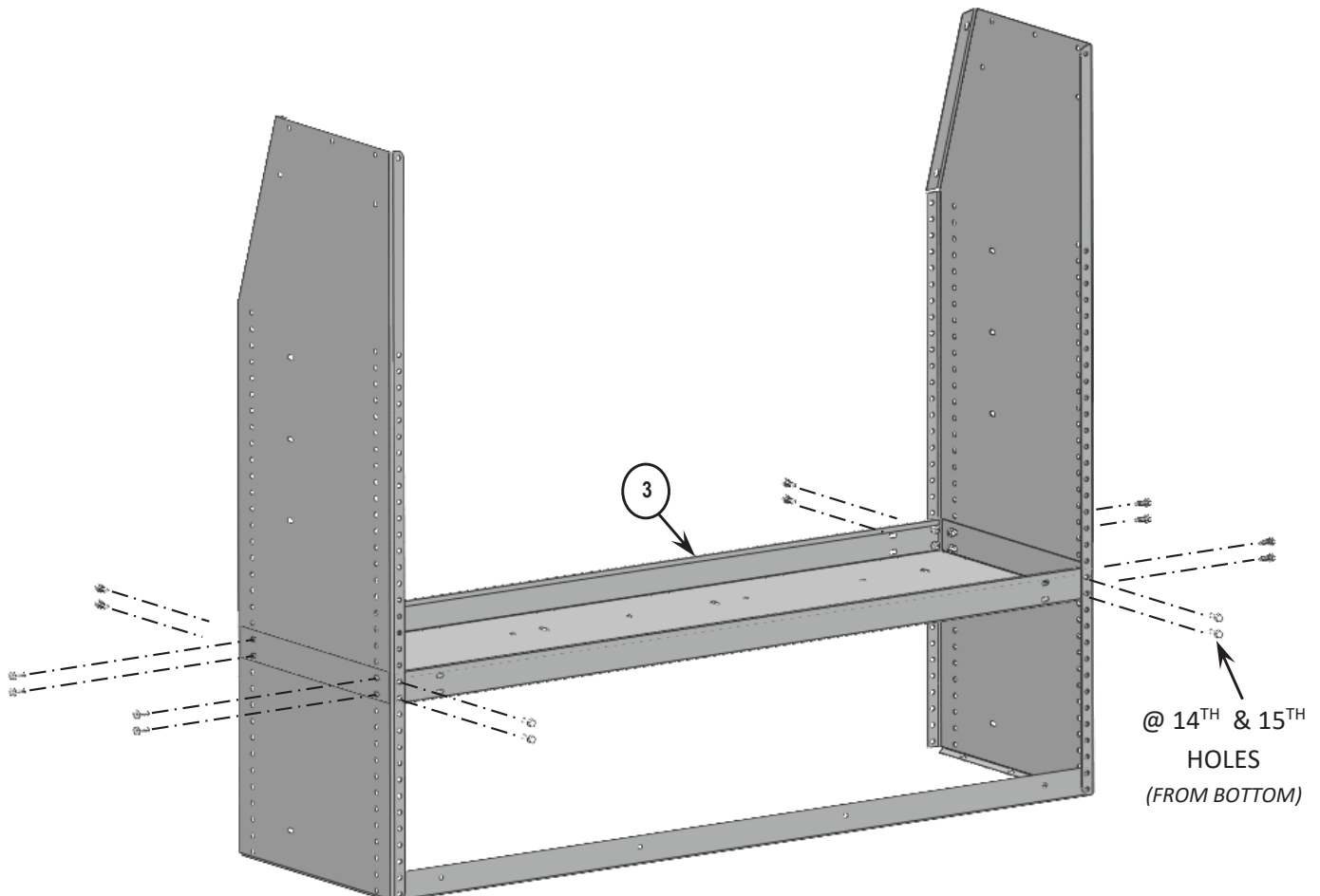



## ■ Attaching Remaining Shelves

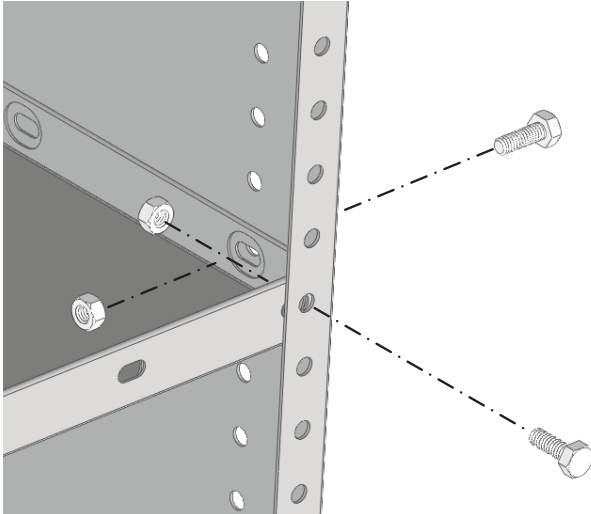

Attaching (2) Shelves as shown, using:  
(16) 1/4-20 x 3/4 Hex Head Screws  
(16) 1/4-20 E-Stop Nuts

**TORQUE SETTING:** Size - 1/4 = 7 - 9.5 Ft. Lbs.

**NOTE:** SHELVES ARE ADJUSTABLE TO FIT REQUIRED NEED. MOUNTING LOCATIONS SHOWN ARE STANDARD MOUNTING LOCATIONS.

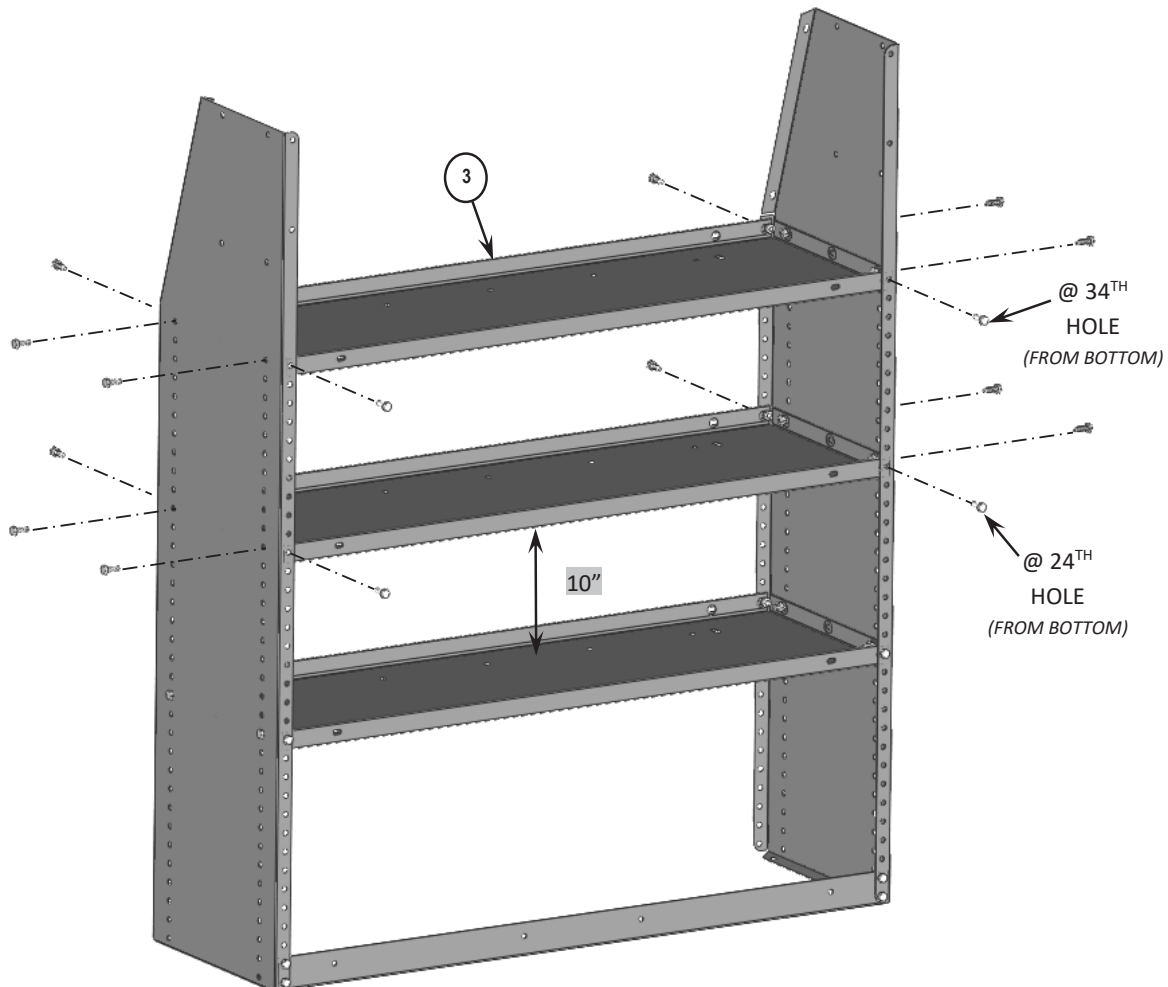

■ **Attaching Remaining Shelves -  
Applicable To Modules With  
Heavy Duty Shelves**

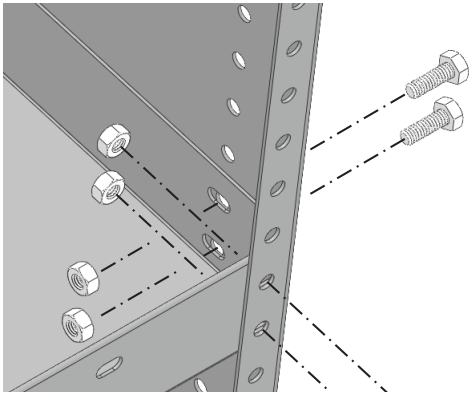

Attaching (2) HD Shelves as shown, using:  
(32) 1/4-20 x 3/4 Hex Head Screws  
(32) 1/4-20 E-Stop Nuts

**TORQUE SETTING: Size - 1/4 = 7 - 9.5 Ft. Lbs.**

**NOTE:** SHELVES ARE ADJUSTABLE  
TO FIT REQUIRED NEED. MOUNTING  
LOCATIONS SHOWN ARE STANDARD  
MOUNTING LOCATIONS.

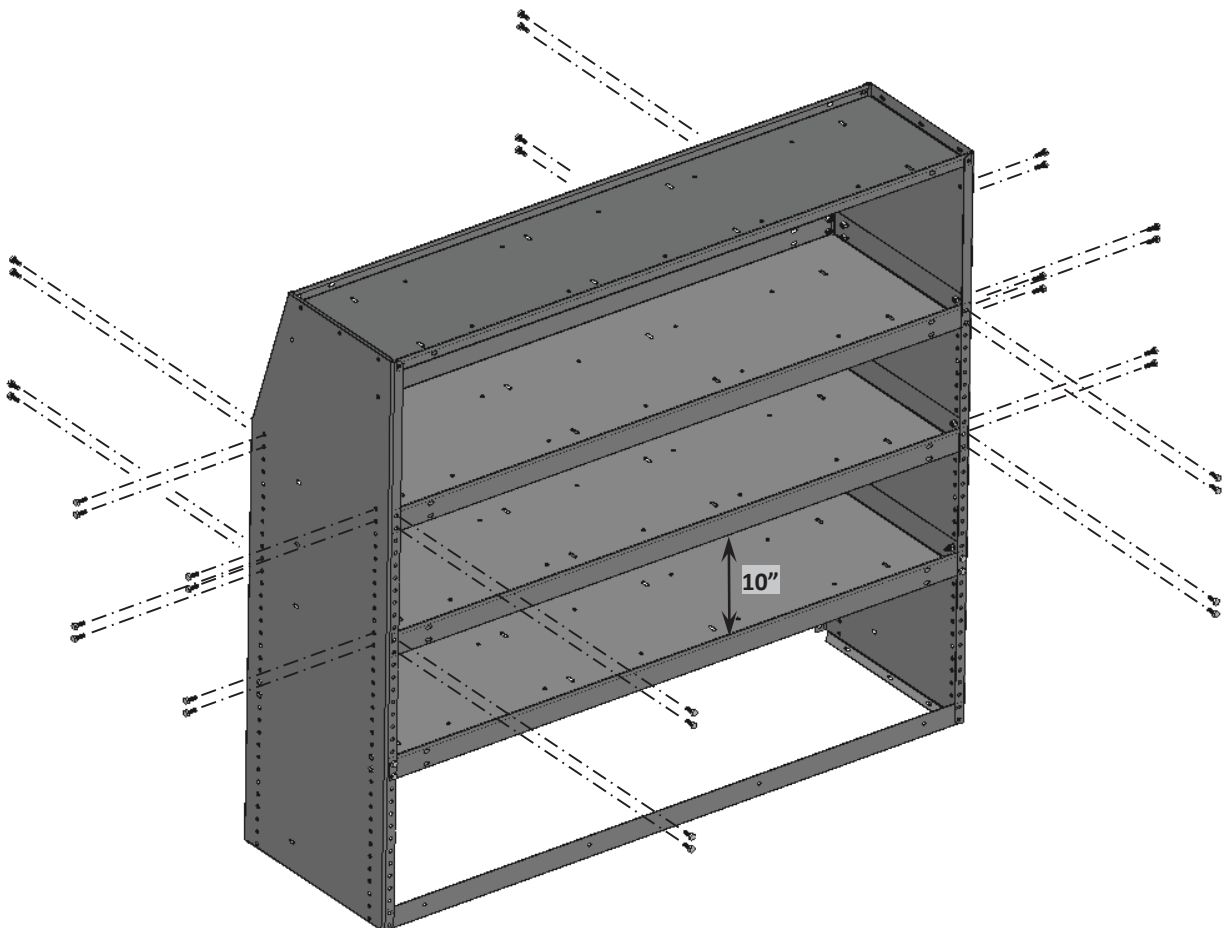

■ **Attaching Top Shelf**

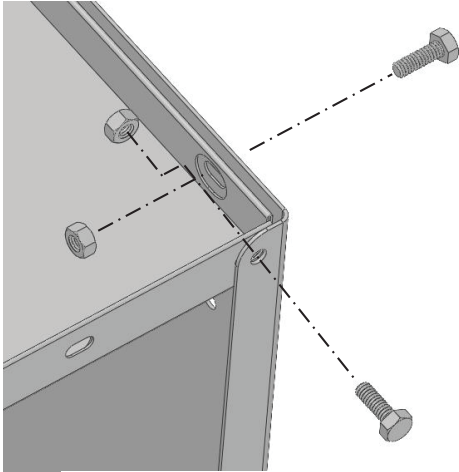

Attach Top Shelf as shown, using:  
(6) 1/4-20 x 3/4 Hex Head Screws  
(6) 1/4-20 E-Stop Nuts

**TORQUE SETTING: Size - 1/4 = 7 - 9.5 Ft. Lbs.**

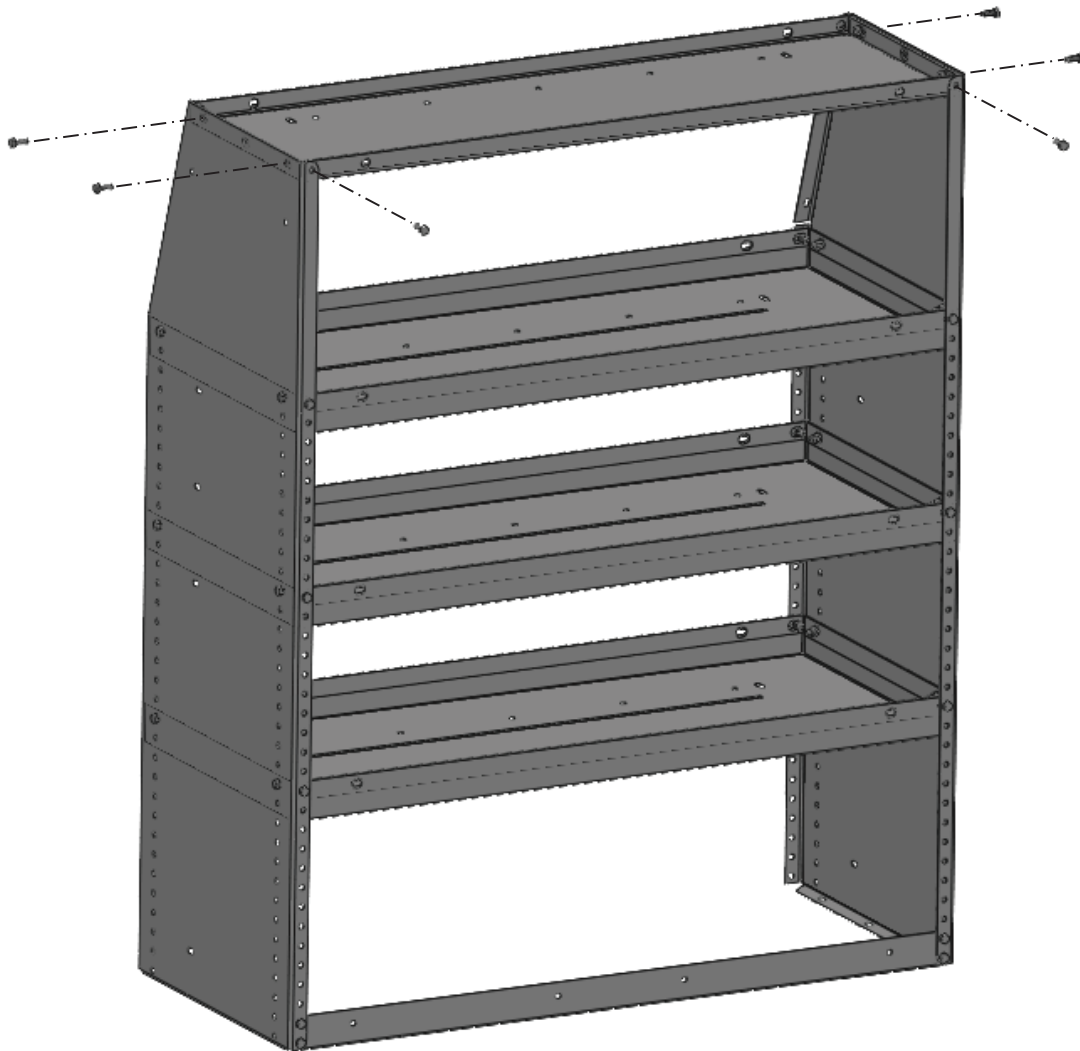

■ **Attaching Tool Drop Tray -  
Applicable To Modules With  
Tool Drop Tray With 2 Shelves**

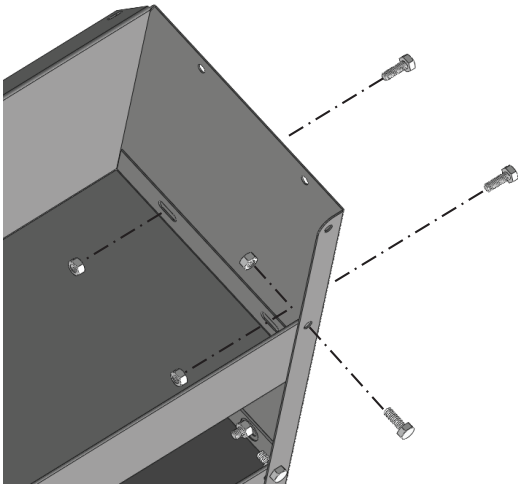

Attach Tool Drop Tray as shown, using:  
(6) 1/4-20 x 3/4 Hex Head Screws  
(6) 1/4-20 E-Stop Nuts

**TORQUE SETTING: Size - 1/4 = 7 - 9.5 Ft. Lbs.**

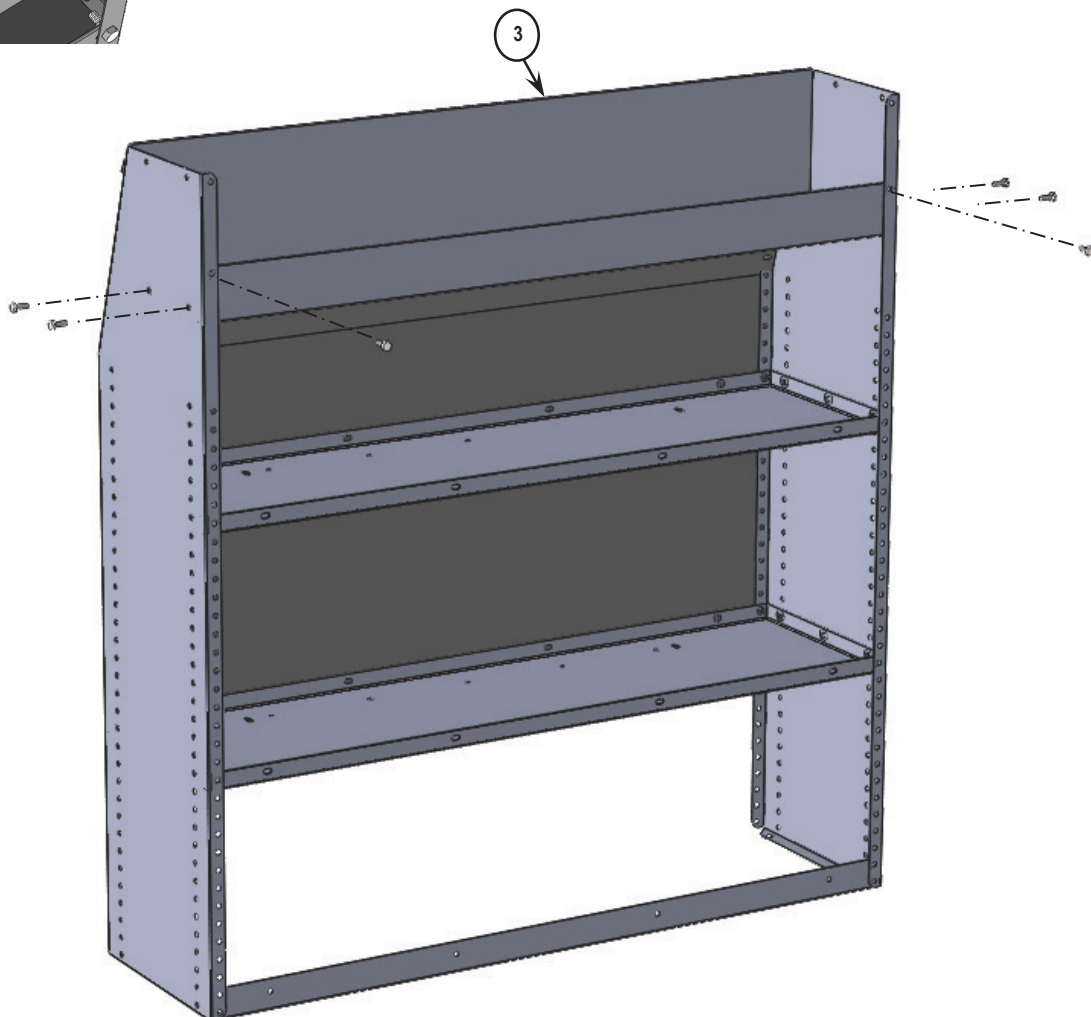

### ■ Attaching Shelf Back

Secure with (8) Fasteners

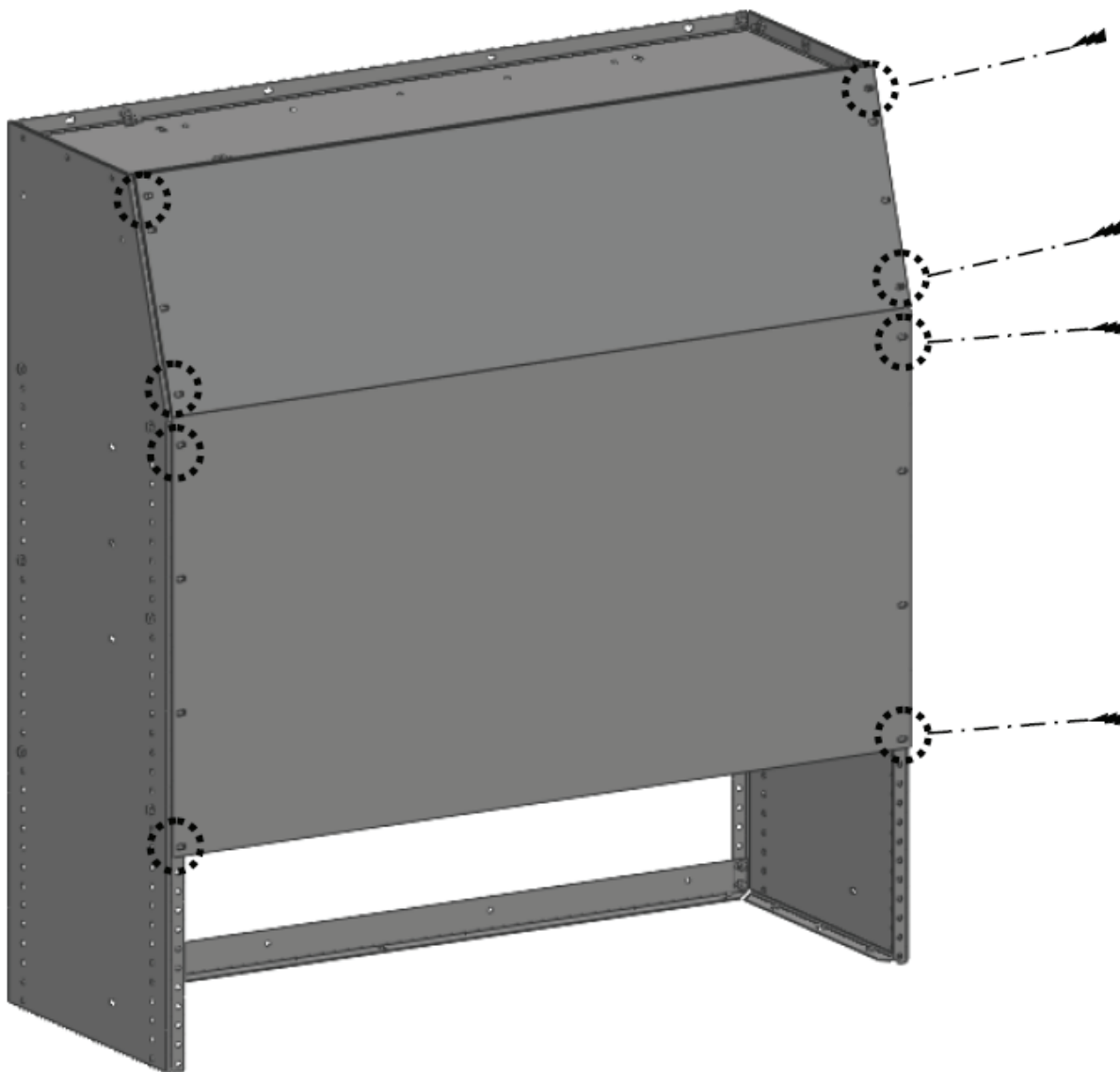

## ■ Standard Installation Heavy Duty T-Bracket

Please read this entire instruction sheet before working on your vehicle and observe the following safety considerations at all times while installing the T-Bracket.

### Step 1

Mark four pilot holes in the upper side rib using the T-Bracket (Item 1) as a template. Remove the T-Bracket and drill 3/8" pilot holes. Install (4) PRE-BULB PLUSNUTS (Item 2) in the 3/8" pilot holes. Use a 1/4-20 x 2-1/2" screw (Item 4) to set the plusnut.

## ■ Required Tools

- Electric Drill
- 3/8" Drill Bit
- 3/8" Drill Stop
- 7/16" Wrench or Socket

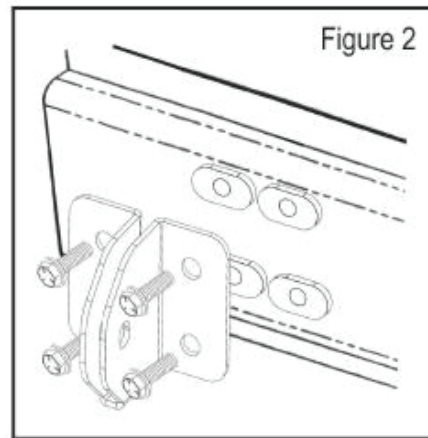

### STEP 2

Attach the T-Bracket using (4) 1/4-20 X 3/4" screw (Item 5). See Figure 2.

### STEP 3

Connect the attachment brace through the middle of the T-bracket using (1) 1/4-20 X 3/4" screw and (1) 1/4-20 elastic stop nut. See Figure 3.

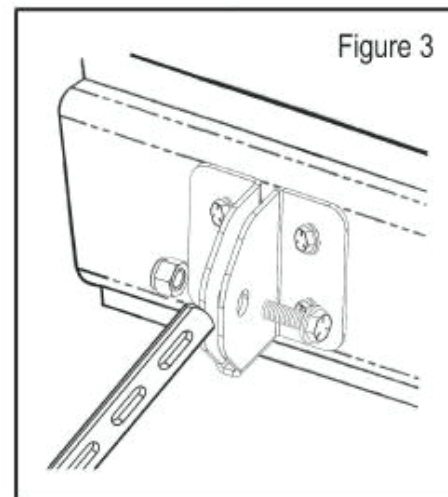

**WEAR SAFETY GLASSES AT ALL TIMES DURING INSTALLATION! CAREFULLY EXAMINE BEHIND ANY DRILLING LOCATION FOR ANY ELECTRICAL WIRING. USE A DRILL STOP IF NECESSARY TO PREVENT DRILL BITS FROM PENETRATING ROOF OR SIDE OF BODY PANELS**

## ■ Standard Installation

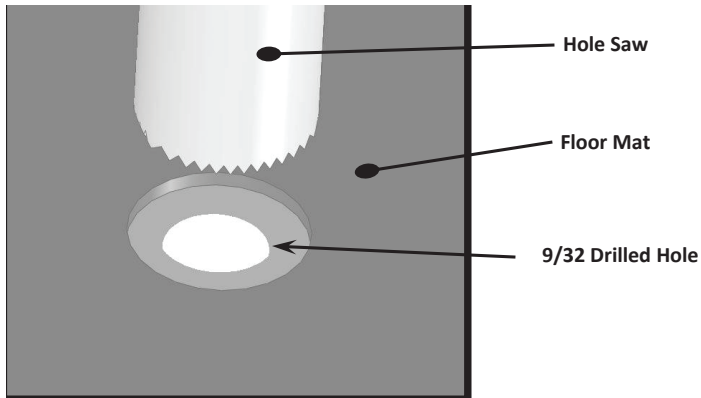

### NOTE:

Using a 1-1/8" Hole Saw specially made for mat cutting, hole saw out all holes in the mat making sure to align hole saw with pre drilled holes. Make sure not to drill through the metal floor of the van. Once drilled clear out each area of excess debris

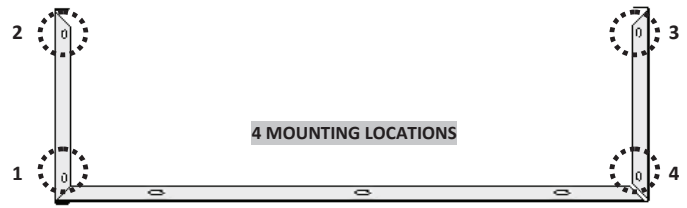

With module properly positioned attach module to floor of vehicle Using either method described below. **NOTE: SPACER ONLY USED WHEN MOUNTING LOCATION FALL IN A VALLEY IN THE FLOOR**



**BEFORE DRILLING - CHECK ALL MOUNTING LOCATIONS TO PREVENT PENETRATING GAS LINES, GAS TANKS, BRAKE LINES, WIRING OR ANY OTHER STRUCTURE OF VEHICLE**

### MOUNTING THROUGH FLOOR (WHERE SPACE PERMITS UNDER VEHICLE)

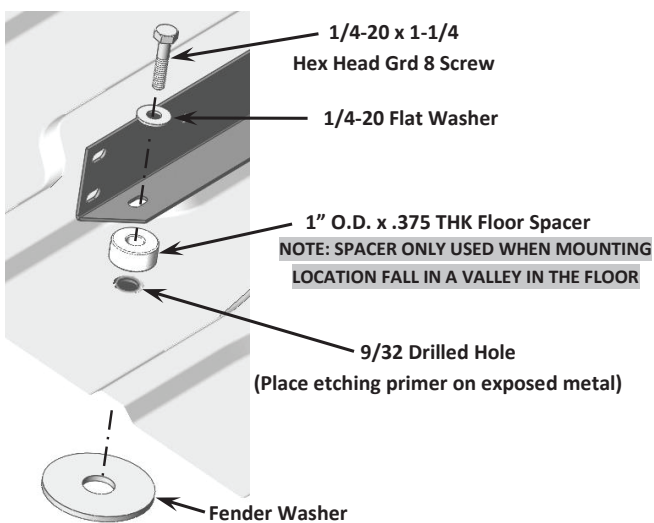

### MOUNTING WITH PLUSNUT (LIMITED SPACE UNDER VEHICLE) (SEE PAGE 14 FOR PLUSNUT INSTALLATION)

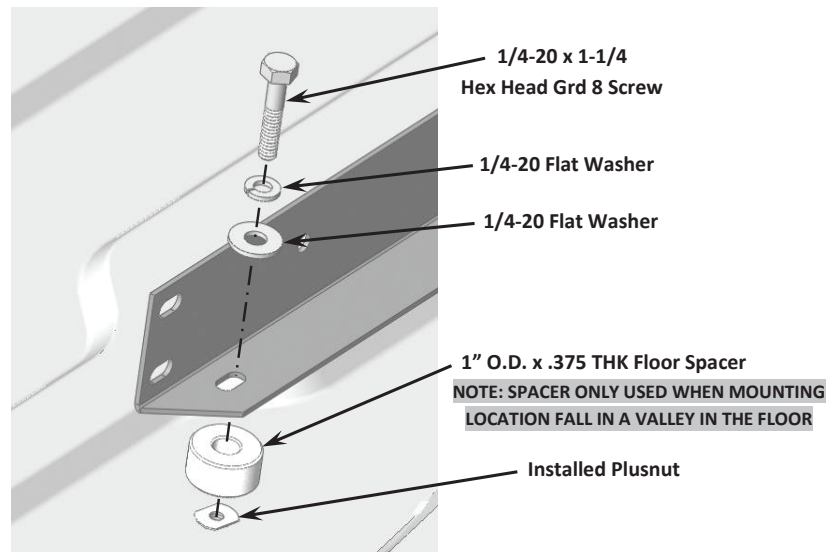

## ■ Plusnut Installation

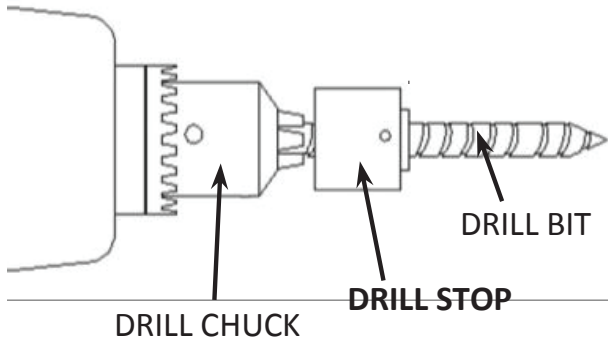

USE DRILL STOP TO  
PREVENT DAMAGING VEHICLE



**BEFORE DRILLING - CHECK  
ALL MOUNTING LOCATIONS  
TO PREVENT PENETRATING  
GAS LINES, GAS TANKS, BRAKE  
LINES, WIRING OR ANY OTHER  
STRUCTURE OF VEHICLE**



The Plusnut® is pre-bulbed for easy installation

1



The Plusnut® is pre-assembled with hex cap and hex bolt.  
Then it is inserted into a pre-drilled hole

2

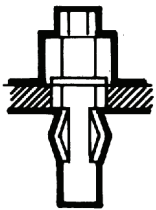

As the bolt is tightened, the Plusnut® upsets  
and provides outstanding  
blind fastening holding power

3

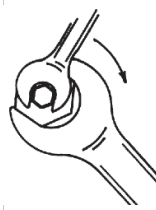

C-500 tool tightens bolt thru hex head cap into Plusnut® A  
ratchet, open-end or closed -end wrench can be used.

4



Fully upset Plusnut® provides  
a reliable nut plate for fastening.

5

### TORQUE SETTING:

Size - 1/4 GRD 5 = 7 - 9.6 Ft. Lbs.

Size - 1/4 GRD 8 = 10 - 13.5 Ft. Lbs.



## MASTERACK® 3 Year / 36,000 Mile Limited Warranty

MASTERACK® commercial van and pickup equipment is warranted to be from defects in material and workmanship, under normal use and service for a period of one (1) year from date of purchase. Factory installations, and products installed in new vehicles by an authorized MASTERACK® installer are warranted for (3) years or 36,000 miles (60,000KM), whichever comes first. **This warranty covers only repairs, or at MASTERACKS' discretion, replacement to correct any defects related to materials and workmanship.**

### **This warranty does not apply to:**

- Additions, alterations, or installations made by persons including dealers, other than MASTERACK® and its authorized distributors, made in accordance with MASTERACK® specifications and / or instructions, nor to defects arising out of attribute to such additions, alterations or installations.
- Defects attributable to abuse or misuse of the product, misapplication, negligent accident, modification or tampering.
- Damage resulting from failure to promptly notify and comply with the instructions of the dealer or manufacturer about defects when noted.
- Any incidental or consequential damages connected with a defect, either while under warranty or afterward, including the cost of a rental truck and / or loss or revenue.

**THE WARRANTY IS THE ONLY WARRANTY APPLICABLE TO A MASTERACK PRODUCT PURCHASE. ALL OTHER WARRANTIES, EXPRESSED OR IMPLIED, INCLUDING BUT NOT LIMITED TO, THE IMPLIED WARRANTIES OR MERCHANTABILITY AND FITNESS FOR A PARTICULAR PURPOSE ARE DISCLAIMED. MASTERACK® AND ITS SUBSIDIARIES, SHALL NOT BE LIABLE FOR ANY INCIDENTAL OR CONSEQUENTIAL DAMAGES ARISING OUT OF ANY BREACH OF THIS WARRANTY, NOR SHALL THE DAMAGES EXCEED THE RETURN AMOUNT OF THE PURCHASE PRICE PAID BY THE ORIGINAL PURCHASER.**

Warranty claims must be submitted to either your sales representative or a customer service representative by calling **1-800-222-8785 or 470-471-8011**. The vehicle must be delivered to the original MASTERACK® authorized dealer for inspection and any warranty service. Any warranty service to be performed by a source other than MASTERACK® location or an approved MASTERACK® distributor must be authorized in advance of the repairs by the MASTERACK® Warranty Administrator and a purchase order issued by MASTERACK® in advance or repairs for the authorized repairs.